

Impact Tools

- ▶ 3/8" - 1" Drive
- ▶ New Titanium Impact Tools
- ▶ Industrial and Maintenance Class Tools
- ▶ Air and Electric Impact Tools
- ▶ Torque Control Impact Tools
- ▶ Full Line of Industrial Grade Sockets

Proven Source. Proven Solutions.

DOBCO
EQUIPMENT LTD

Ontario's Largest
Pneumatic & Hydraulic Tool Distributor

1-2430 Lucknow Drive, Mississauga, Ontario L5S 1V3. Tel: 905-672-5557 Fax: 905-672-5559
Email: sales@dobcoeqp.com www.dobcoeqp.com



IR Ingersoll Rand®
www.irtools.com

Notes



Lined writing area with horizontal grey lines for text entry.

Proven Source

Throughout its history, Ingersoll-Rand has earned a global reputation for creating tools that solve problems, build productivity, and put more power in the hands of the user. Ingersoll-Rand has been manufacturing impact tools for over seventy years, starting out as the original pioneer, and today leading the marketplace in design and development of the broadest impact tool selection in the world.

Proven Solution

Ingersoll-Rand continues to create innovative products that provide solutions for customers. Our impact tool line is no different. Recent design

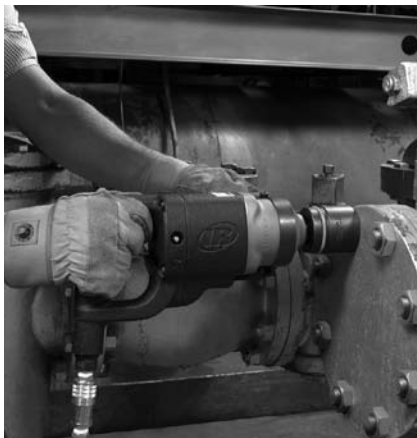

Model 2925B2Ti

improvements, such as the incorporation of titanium, make our tools stronger and lighter than any other impact tool on the market. The latest 2115 and 2135 Titanium series impact tools both lead the industry as the most powerful and lightest weight tools in their class. Ingersoll-Rand is constantly evolving its product categories and you can expect continued innovations providing productivity solutions.

Industrial Production Class Impact Tools

The toughest industrial applications in the world run 24-hours a day, 7 days a week, 365 days a year...that's why Ingersoll-Rand is dedicated to manufacturing impact tools that can hold up to your toughest jobs. Ingersoll-Rand Industrial Production Class impact tools are designed with durability in mind, from the vanes turning the motor to the hammer frames and anvils. Proprietary hardening and treatment processes, innovative ergonomic design, and excellence in manufacturing all add up to the longest lasting, hardest hitting impact tools in the business.



Model 232TGSL

Maintenance / Automotive Class Impact Tools

Ingersoll-Rand impact tools are the brand of choice for professional automotive mechanics and the racing teams of NASCAR. Maintenance / Automotive class impact tools are designed for those applications that aren't as demanding as those for industrial production. Applications best suited for tools in this class involve intermittent use such as basic maintenance and light production.

Air Impact Tools Introduction



Throughout the section, page headings let you know what category the tool falls in. For assistance in determining the correct tool for your application please contact your Ingersoll-Rand sales representative or Ingersoll-Rand customer service.



High Performance Ergonomics

Three Types of Impact Tool Mechanisms



Twin-Hammer

A simplified, yet highly effective design that holds each of the reversible hammers in full engagement or disengagement with centrifugal force. The twin-hammer mechanism delivers more power per pound, and is less sensitive to air pressure fluctuations than any other design.

- Smooth, balanced blow
- High power-to-weight ratio
- Suitable for hard or soft-draw applications



Jumbo Hammer

Similar in concept to the twin-hammer mechanism, but employing a single hammer.

- Simplified design
- Reversible hammers
- Direct drive

Ball and Cam

Precision mechanism converts motor torque into powerful rotary impacts. The ball and cam mechanism is ideal for soft draw applications, and is utilized in larger Impact Tools, as well as in all torque control and electric Impact Tools.

- Air or electric
- Does not stall
- A time-tested design



Configurations

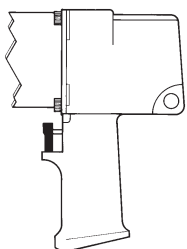

Pistol

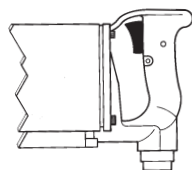

Inside Grip

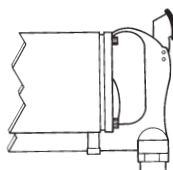

Outside Grip

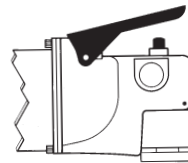

Straight

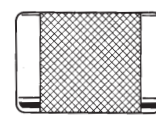

Quick Change

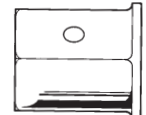

Square Drive

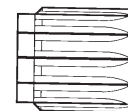

Spline Drive



Ingersoll-Rand takes pride in the fact that we produce the best industrial products available. However, even the most robust designs require maintenance. When your IR tool, or other IR equipment, requires maintenance or repair, insist on Genuine IR parts and service. Remember, nothing keeps your equipment and tools running better than the original parts they were designed to work with.



Vanes

State of the art, fiber reinforced, engineered polymers ensure top performance from critical parts. IR is constantly looking for ways to increase the power and durability of their impacts.



Vanes w/motor

Tight production tolerances, robust designs and optimized performance provide the user with the best of both worlds: performance and reliability.



Hammer frame and anvil

Proprietary hardening and treatment processes reduce wear and drastically extend tool life. Working with industry leaders, IR tools are the best by design.



Endplates

Easily serviceable parts, simplified components and unique features give the longest tool life available, and the shortest downtime. Meaning increased productivity for our customers.



Cylinder and hammers

Unique metallurgy and chemical treatment processes have been perfected over the 70+ years that Ingersoll-Rand has been producing impact tools. These processes reduce the susceptibility of many components to wear that most other tools experience. From the very start, IR has worked to make their industrial products the very best that they can be.



Call 1-866-474-8665

Ingersoll-Rand, the leader in industrial impact tools, is continuously striving for excellence. Through improvement in design and process, our products are the best they can be. Why settle for less? Demand IR genuine parts and services for your business.

A New Standard of Performance

280 ft.-lbs. of Torque in a tool weighing just 2.4 lbs.



The IR2115PTi
3/8" Drive Model

Ultimate productivity means using the right tool for the job. That's why we're building a Titanium team, with the 2115PTi 3/8" drive model—the perfect tool for tight spaces, where access is critical, and power and control can really make a difference. Like the 2135PTi, it delivers class-leading torque output in an even smaller size, measuring just 1.7" across the hammer case. It incorporates the same great design features, including an enhanced Twin Hammer impact mechanism for fast bolt removal, a professional touch trigger for smooth, precise power delivery, and more.

Two tools for two types of tasks.
The IR Titanium Team is ready.

from the Leader in Impact Tools.

1000 ft.-lbs. of Nut Busting Torque in a tool weighing just 3.9 lbs.



The R2135PTi
1/2" Drive Model

Ingersoll-Rand has pioneered the use of Titanium to create impact tools that deliver class-leading power in the most compact, lightweight packages available. The new 2135PTi 1/2" drive model produces 700 ft.-lbs. of traditional torque output, and 1000 ft.-lbs. of Nut Busting Torque—it will remove a bolt tightened to 1000 ft.-lbs. in just 6 seconds. Its seven vane motor and efficient air flow help reach peak torque quickly, and get more work done in less time. But all of this power is easy to control, with a comfortable ergonomic handle and grip, convenient pushbutton forward reverse controls for one-handed operation, a four-position power management dial, plus a 360-degree swivel inlet and through-handle exhaust. Its exclusive combination of Titanium and composite construction will withstand the toughest operating conditions, and help you establish a new standard of productivity.

Air Impact Tools

3/8" Industrial Production Class



IR 2902P1

3/8" Air Impact Wrench

The 2902P1 is Ingersoll-Rand's most durable 3/8" impact wrench. It's designed for serious industrial and production environments that require tools that will last.

- Steel hammer case
- Epoxy coated motor housing and handle
- Built in power regulator
- Jumbo hammer mechanism



IR 1702P1

3/8" Air Impact Wrench

The 1702P1 is our most popular, industrial 3/8" impact. A great all purpose tool, the 1702P1 is designed for those applications not as demanding as those for the 2902P1.

- Steel hammer case
- Built in power regulator
- Pressure feed impact mechanism lubrication



IR 1702SB1

3/8" Air Impact Wrench

Our newest 3/8" drive model combines power and economy for general service applications. It provides adjustable power output in forward and reverse with handle exhaust to direct air away from the operator and the work.

- 160 ft.-lbs. of maximum torque
- Two-piece housing for easy service
- Comfortable ergonomic handle design



Hanger not included

IR 2115PTi

3/8" Air Impact Wrench

The 2115PTi is Ingersoll-Rand's smallest, lightest, & hardest hitting 3/8" industrial impact wrench. Incorporating a titanium hammer case and a composite body for added durability.

- Small size is great for tight spots
- 280 ft.-lbs. max torque
- Only 2.4 lbs.
- Ergonomic, composite handle for operator comfort



Options Available

Series 1702

- Vertical hanger No. 1901-365 (B)
- Exhaust muffler kit No. 212-K23 (P)
- Horizontal hanger No. 1901-366

Series 2902

- Vertical hanger No. 1901-365 (B)
- Horizontal hanger No. 1901-366 (P&B)

Series 2903

- Vertical hanger No. 2908-365
- Horizontal hanger No. 1901-366

Model	Drive Description	Handle	Free Speed rpm	Impacts per minute	Maximum Torque		Recomm. Torque Range		Weight, less socket		Length, less socket		Side to Center Distance		Size Hose Recomm.		cfm
					ft.-lb.	Nm	ft.-lb.	Nm	lb.	kg	in.	mm	in.	mm	in.	mm	
2902P1	3/8" square	Pistol	10,000	1500	140	190	20-120	27-163	2 1/2	1.25	5 1/2	140	1 3/8	35	5/16	8	15
2903P2	3/8" square	Pistol	6000	1200	205	278	30-170	41-230	4 13/16	2.18	5 5/8	143	1 3/8	35	3/8	10	21
2115PTi	3/8" square	Pistol	15,000	1500	250F	339	25-250	34-312	2.4	1.1	5 3/4	146	1 1/8	29	3/8	10	17
	Reverse Bias				280R	378											
2115P4Ti	1/4" hex QC	Pistol	15,000	1500	250F	339	25-230	34-312	2.4	1.1	5 3/4	146	1 1/8	29	3/8	10	17
	Reverse Bias				280R	378											

Super Duty Impact Tools

1702SB1	3/8" square	Straight	10,000	1500	105	142	13-85	18-115	2 1/2	1.12	5 7/8	149	1	25	5/16	8	13
1702P1	3/8" square	Pistol	10,000	1500	125	170	20-100	27-136	2 3/4	1.25	5 1/2	140	1 3/8	35	5/16	8	15
1702P4	1/4" hex QC	Pistol	10,000	1500	125	170	20-100	27-136	2 3/4	1.25	5 1/2	140	1 3/8	35	5/16	8	15

"QC" designates a Quick Change chuck.

Note: All of the above square drive Impact Tools furnished with pin-type retainer. Performance figures are at 90 psi (620kPa) air pressure.

IR2115Ti

3/8" Titanium Duty

Mini Air Impact Wrench

The new IR2115Ti is the world's most powerful and compact 3/8" impact. The streamlined titanium hammer case allows the user to access fasteners that other bulky impacts can't reach. The 280 ft.-lbs. of torque

will remove even the toughest nuts and bolts. The IR2115Ti excels on all of your automotive applications: transmissions, brakes, exhaust, body repair, and under hood.

- 280 ft.-lbs. maximum torque
- 15,000 rpm
- 2.4 lbs.
- Titanium Strength



IR212

3/8" Super Duty

Air Impact Wrench

Tremendous power and longer life make this wrench the popular choice of professional mechanics for exhaust systems, air conditioning, radiators, body shop, and bench work. Still the most powerful 3/8" pistol-grip on the market, it offers all the advantages of the Single Hammer Impact Mechanism for removing and replacing bolts up to 7/16" without a struggle.

- Power up to 180 ft.-lbs
- Unaffected by air pressure changes
- More torque, less vibration
- Pistol-style yet extremely compact and lightweight
- Built-in power regulator prevents over-torquing
- Handle exhaust



IR215

3/8" Heavy Duty

Air Impact Wrench

Our newest 3/8" drive model combines power and economy for general service applications. It provides adjustable power output in forward and reverse with handle exhaust to direct air away from the operator and the work.

- 160 ft.-lbs. of maximum torque
- Two-piece housing for easy service
- Comfortable ergonomic handle design



IR216

3/8" Super Duty

In-Line Air Impact Wrench

The IR216 puts power and ergonomics in the palm of your hand. This durable in-line wrench is handy for the small cramped spaces common to small engine repair and other general service work. The butterfly-style throttle valve lets you adjust speed smoothly in either direction in one continuous motion.

- The most powerful 3/8" palm-grip wrench you can get
- 175 ft.-lbs. of torque
- Contoured composite butterfly throttle for comfort and control
- Recessed regulator dial



Model Number	Performance Rating	Maximum Torque ft.-lb. (Nm)	Free Spd. (rpm)	Weight lbs. (kg)	Length in. (mm)	Av. Air Consump. cfm (l/min)	@ Load cfm (l/min)	Sound dBA (Press./Power)	Air Inlet NPTF in.	Min. Hose Size in. (mm)
3/8" Square Drive										
IR211	Heavy Duty	150 (204)	10,000	2.4 (1.09)	6.6 (168)	2.5 (71)	11 (311)	104/117	1/4	3/8 (10)
IR212	Super Duty	180 (245)	10,000	2.89 (1.31)	6 (152)	2.5 (71)	11 (311)	97.5/110.5	1/4	3/8 (10)
IR215	Heavy Duty	160 (217)	9,500	2.89 (1.31)	6.125 (156)	3.0 (84)	13 (364)	80.6/93.6	1/4	3/8 (10)
IR216	Super Duty	175 (232)	8,000	2.89 (1.31)	6.125 (156)	3.0 (85)	13 (368)	97.5/110.5	1/4	3/8 (10)
IR2115Ti	Titanium Duty	260 (354)	14,500	2.65 (1.20)	5.625 (143)	4 (113)	17 (476)	94.9/107.9	1/4	3/8 (10)

* Maintenance/Automotive class tools are designed for maintenance and automotive applications involving intermittent use.

Air Impact Tools
1/2" Industrial Production Class

IR 2906P1

1/2" Air Impact Wrench

The 2906P1 is Ingersoll-Rand's most durable 1/2" impact wrench. It's designed for serious industrial and production environments that require a tool to last 24 hours a day, 7 days a week.

- Steel hammer case
- Built in lubricator
- Built in power regulator
- Two-piece motor housing



IR 2707P1

1/2" Air Impact Wrench

The 2707P1 is designed for applications not as demanding as those for the 2906P1, making it a great general purpose industrial tool.

- Steel hammer case
- Built in power regulator
- Pressure feed impact mechanism lubrication



IR 2135PTi

1/2" Air Impact Wrench

The 2135PTi is Ingersoll-Rand's newest 1/2" impact wrench and incorporates titanium technology to create the lightest weight, hardest hitting impact in its class.

- Titanium hammer case is light weight and durable
- 700 ft.-lbs. of maximum torque
- Only 3.95lbs.
- Ergonomic, composite handle for operator comfort



IR 2705P1

1/2" Air Impact Wrench

Designed for light industrial use, the 2705P1 is an economical alternative for an industrial grade tool. It's well suited for industrial maintenance applications.

- Steel hammer case
- Built in power regulator
- Epoxy coated motor housing and handle



Options Available

Series 2903, 2908

- Vertical hanger No. 2908-365

Series 2705

- Vertical hanger No. 904-366

Series 2135

- Vertical hanger No. 2131-366

Model	Drive Description	Handle	Free Speed rpm	Impacts per minute	Maximum Torque ft.-lb.	Maximum Torque Nm	Recomm. Torque Range ft.-lb.	Recomm. Torque Range Nm	Weight, less socket lb.	Weight, less socket kg	Length, less socket in.	Length, less socket mm	Side to Center Distance in.	Side to Center Distance mm	Size Hose Recomm. in.	Size Hose Recomm. mm	cfm
-------	-------------------	--------	----------------	--------------------	------------------------	-------------------	------------------------------	-------------------------	-------------------------	------------------------	-------------------------	------------------------	-----------------------------	----------------------------	-----------------------	----------------------	-----

Super Duty Impact Tools

2906P1	1/2" square	Pistol	5000	1200	500	678	40-350	54.2-475	6	2.72	6 7/8	175	1 11/32	34	3/8	10	23
2903P1	1/2" square	Pistol	6000	1200	220	298	30-185	41-250	4 13/16	2.18	5 5/8	143	1 3/8	35	3/8	10	21

Heavy Duty Impact Tools

2707P1	1/2" square	Pistol	7750	1300	450	610	40-275	54-373	6	2.72	6 1/2	165	1 3/8	35	5/16	8	26
--------	-------------	--------	------	------	-----	-----	--------	--------	---	------	-------	-----	-------	----	------	---	----

Standard Duty Impact Tools

2135PTi	1/2" square Reverse Bias	Pistol	9500	1250	625	848	50-600	68-814	3.95	1.79	7.34	186	1 3/8	35	3/8	10	24
2131P7	7/16" hex QC Reverse Bias	Pistol	9500	1250	625	848	50-600	68-814	3.95	1.79	7.34	186	1 3/8	35	3/8	10	24
2705P1	1/2" square	Pistol	8500	1200	400	542	40-200	54-271	5 5/8	2.55	6 3/4	171	1 11/32	34	3/8	10	23
2125PTi	1/2" square Reverse Bias	Pistol	15,000	1500	290	339	25-230	34-312	2.4	1.1	5 3/4	146	1 1/8	29	3/8	10	17

All of the above square drive Impact Tools furnished with pin-type retainer. Performance figures are at 90 psi (620 kPa) air pressure.

IR231HA

1/2" Super Duty Air Impact Wrench

The 231 Series has set the standard for impact performance for over three decades. Refined engineering design has perfected the performance that has made the IR231 series the most popular impact ever, rivaled only by IR's composite impacts. IR's elite mechanism is the perfect balance between superior power and proven durability.

- Handle exhaust directs air away from user
- Contoured comfort handle
- 590 ft.-lbs. maximum torque
- Pressure feed lubrication system
- Adjustable Power Regulation



IR231HA-2

1/2" Super Duty Air Impact Wrench

Extended Anvil

Featuring a 2" extended anvil with all the performance benefits found in the IR231HA. Ideal for tire changing and use with flip sockets.

IR244A

1/2" Super Duty

Air Impact Wrench

Bring out the "big gun" for tire-changing, shock and spring work, front end work, and other heavy automotive and truck work. The impact mechanism pumps out 500 ft.-lbs. torque at a free speed of 7,000 rpm to get the job done fast.

- Powerful, with smooth, balanced blows
- Pressure Feed Lubrication System automatically greases the impact mechanism



IR244A-2

1/2" Super Duty Extended Anvil

Air Impact Wrench

Specifically designed for heavy tire changes, this is the "twin" of the IR244, but with a 2" extended anvil you use with flip sockets.

IR235

1/2" Heavy Duty

Air Impact Wrench

Ingersoll-Rand has packed more power, features, and durability into its most economical 1/2" drive impact wrench. This tool delivers 375 ft.-lbs. of maximum torque with a free speed of 9,500 rpm, to make easier work of general service applications.

- 375 ft.-lbs. of maximum torque
- Handle exhaust
- Balanced design with easy-to-use controls, tease trigger
- Full power in reverse; adjustable power in forward
- High output impact mechanism



IR232TGSL

Street Legal™ ThunderGun®

1/2" Super Duty

Air Impact Wrench

This is our fastest 1/2" impact wrench... and as close as you can get to the real racing tools preferred by NASCAR tire changers. It features 625 ft.-lbs. of torque in reverse, with 10,000 rpm to deliver pit crew power, speed, and durability for shop tasks.

- Distinctive appearance, similar to the IR ThunderGun racing tool
- Adjustable power regulator
- Our fastest 1/2" impact wrench!



Model Number	Performance Rating	Maximum Torque ft.-lb. (Nm)	Av. Free Spd. (rpm)	Weight lbs. (kg)	Sound Length in. (mm)	Air Air Consump. cfm (l/min)	Min. @ Load cfm (l/min)	dBA (Press./ Power)	Inlet NPTF in.	Hose Size in. (mm)
IR231HA	Super Duty.	590 (816)	8,000	5.8 (2.63)	7.3 (185)	4.2 (119)	22 (623)	91.2/104.2	1/4	3/8 (10)
IR231HA-2	Spr.Dty.Ext.Anv.	590 (816)	8,000	6.1 (2.76)	9.5 (241)	4.8 (136)	23 (651)	89/102	1/4	3/8 (10)
IR244A	Super Duty	500 (680)	7,000	6 (2.72)	7.3 (185)	5.4 (153)	21 (595)	105/109.3	1/4	3/8 (10)
IR244A-2	Spr.Dty.Ext.Anv.	500 (680)	7,000	6.28 (2.85)	9.5 (241)	5.4 (153)	21 (595)	105/109.3	1/4	3/8 (10)
IR235	Heavy Duty	375	9,500	5.42 (2.46)	7.75 (197)	4 (113)	17 (474)	104.2/111.6	1/4	3/8 (10)
IR232TGSL	Super Duty.	625 (847)	10,000	6 (2.72)	7.3 (185)	5.4 (153)	21 (595)	105/109.3	1/4	3/8 (10)

*Maintenance/Automotive class tools are designed for maintenance and automotive applications involving intermittent use.

Air Impact Tools

1/2" Maintenance/Automotive Class*

IR2125QTi

1/2" Titanium Duty

Mini Air Impact Wrench

The 1/2" drive version of the new IR2115Ti Titanium Impact. Superior power in a lightweight package.



IR231C

1/2" Super Duty

Air Impact Wrench

The classic IR231 is the most popular tool in its class. Introduced over 25 years ago and continuously refined, it offers the sheer power and performance features to tackle the toughest jobs with ease – as well as proven durability and economy.

- Exclusive impact mechanism
- Pressure-feed lubrication
- Adjustable power regulator
- Easy to service two-piece construction
- Contoured handle for comfort and control



IR225

1/2" Heavy Duty

Air Impact Wrench

The new IR225 "mini" air impact wrench brings power and speed to motorcycle service, small engine repair and transmission work, and other applications involving tight spaces.

Plus, its many comfort and convenience features make it a great value.

- 325 ft.-lbs. of maximum torque
- Six-position power management in forward and reverse
- Handle exhaust directs air away from the operator and the work



1/2" Drive Impact Tool Sockets

Cat. No.	Description
74411	1/2" drive set (7/16, 1/2, 9/16, 5/8, 11/16, 3/4, 13/16, 7/8, 15/16, 1, 1-1/16, metal tray)
73412	1/2" drive deep set (3/8, 7/16, 1/2, 9/16, 5/8, 11/16, 3/4, 13/16, 7/8, 15/16, 1, metal tray)
74466M	1/2" drive metric set (10, 11, 12, 13, 14, 15, 16, 17, 18, 19, 20, 21, 22, 23, 24, 27, metal tray)
73467M	1/2" drive deep metric set (10, 11, 12, 13, 14, 15, 16, 17, 18, 19, 20, 21, 22, 23, 24, 27, metal tray)



Model Number	Performance Rating	Maximum Torque ft.-lb. (Nm)	Av. Free Spd. (rpm)	Weight lbs. (kg)	Sound Length in. (mm)	Air Air Consump. cfm (l/min)	Min. @ Load cfm (l/min)	dBA (Press./Power)	Inlet NPTF in.	Hose Size in. (mm)
--------------	--------------------	-----------------------------	---------------------	------------------	-----------------------	------------------------------	-------------------------	--------------------	----------------	--------------------

1/2" Square Drive

IR2125QTi	Titanium Duty	260 (312)	14,500	2.65 (1.2)	5.625 (143)	4 (113)	17 (476)	94.9/107.9	1/4	3/8 (10)
IR225	Heavy Duty	325 (441)	7,500	4.25 (1.93)	6.625 (168)	4 (113)	16.3 (456)	90.5/103.5	1/4	3/8 (10)
IR231C	Super Duty	600 (816)	8,000	5.8 (2.63)	7.3 (185)	4.2 (119)	22 (623)	102/115	1/4	3/8 (10)

* Maintenance/Automotive class tools are designed for maintenance and automotive applications involving intermittent use.

IR2135Ti

1/2" Titanium Duty Air Impact Wrench

The Titanium IR2135Ti delivers 1,000 ft.-lbs. of Nut Busting Torque in a gun that weighs just 3.95 lbs! The 7-vane power plant drives enough torque to break away a nut tightened to over 1,000 ft.-lbs. in under six seconds.

- 1,000 ft.-lbs. of Nut Busting Torque
- Traditional max. torque of 700 ft.-lbs.
- New ergonomically designed handle
- Easy-to-use forward/reverse push buttons
- Professional touch trigger for precision control
- Power control dial
- Titanium Technology



IR2135Ti-2

1/2" Titanium Duty Air Impact Wrench Extended Anvil

Featuring a 2" extended anvil with all the performance benefits found in the IR2135Ti. Not many lug nuts can stand in the way of Titanium power. Ideal for tire changing and use with flip sockets.

IR2135QTi

1/2" Titanium Duty Air Impact Wrench

Powerful and Quiet! New technology developed by IR has reset the standard for quiet technology coupled with raw power. The quiet version of IR's strongest 1/2" impact is perfect for high volume tire shops and other applications involving frequent use.

- Patented technology silences the tool without sacrificing the power required for tough applications
- New ergonomically designed handle
- Titanium Technology



IR2135QTi-2

1/2" Titanium Duty Air Impact Wrench Extended Anvil

Featuring a 2" extended anvil with all the performance benefits found in the IR2135QTi. Ideal for tire changing and use with flip sockets.

IR2130

1/2" Heavy Duty Air Impact Wrench

The new IR2130 has all the performance and features you have come to expect from the IR family of Impact wrenches. This Impact features a powerful twin hammer mechanism and a new composite housing, yielding superior ergonomics in a lightweight package.

- 600 ft.-lbs. of maximum Torque
- Full stroke tease throttle
- Easy glide forward/reverse switch
- Multi position power management
- Lightweight reinforced aluminum hammercase



IR2130-2

1/2" Heavy Duty Air Impact Wrench Extended Anvil

Featuring a 2" extended anvil with all the performance benefits found in the IR2130. Ideal for tire changing and use with flip sockets.

Protect your tool investment with Ingersoll-Rand Impact Tool boots. Tool boots cover the front end of your impact and prevent knicks and scratches from marring the look of your new tool. They are also a great way to individualize and differentiate your tool from everyone else's.

Model	Impact Tool
2131-P32	2131, 2131P, 2131QT-2, 2131QT
2135-P32	2135Ti, 2135Ti-2, 2135PTi, 2135PTi-2
202-P32	212
2112-P32	2112
235-P32	235
231-P32	231C
244-P32	244A
225-P32	225
255-P32	255
2141-P32	2141
2161-P32	2161
295-P32	295



Model Number	Performance Rating	Maximum Torque ft.-lb. (Nm)	Free Spd. (rpm)	Weight lbs. (kg)	Length in. (mm)	Av. Air Consump. cfm (l/min)	@ Load cfm (l/min)	Sound dBA (Press./Power)	Air Inlet NPTF in.	Min. Hose Size in. (mm)
IR2130	Heavy Duty	600 (814)	9,500	4.2 (1.9)	7.25 (184)	4.4 (124.6)	22 (623)	96.6/109.6	1/4	3/8 (10)
IR2130-2	Heavy Duty	600 (814)	9,500	4.55 (2.05)	9.25 (235)	4.4 (124.6)	22 (623)	96.6/109.6	1/4	3/8 (10)
IR2135Ti	Titanium Duty	700 (950)	9,500	3.95 (1.79)	7.34 (186.4)	5 (142)	24 (680)	101/114	1/4	3/8 (10)
IR2135Ti-2	Titanium Duty.	700 (950)	9,500	4.4 (2.0)	9.34 (237)	5 (142)	24 (680)	101/114	1/4	3/8 (10)
IR2135QTi	Titanium Duty	700 (950)	9,500	4.05 (1.84)	7.34 (186.4)	5 (142)	24 (680)	86/96	1/4	3/8 (10)
IR2135QTi-2	Titanium Duty.	700 (950)	9,500	4.4 (2.0)	9.34 (237)	5 (142)	24 (680)	86/96	1/4	3/8 (10)

*Maintenance/Automotive class tools are designed for maintenance and automotive applications involving intermittent use.

IR2925P Series Impact Tools

A new generation of Impact Tools

The unique features of the 2925 Series extend to pistol grip configurations in the 2925P Models. They offer an unmatched combination of performance and control, with the durability to withstand the toughest operating conditions.

External features include:

- Titanium hammer case
- Ergonomic handle design
- Smooth contoured profile with integral grip ledge
- Three-piece housing
- Handle exhaust
- Contoured trigger
- Minimum side-to-center distance
- Enhanced pressure-feed lubrication system
- Low profile reverse lever
- Three-position power regulation and forward/reverse control
Position #1 = Full
#2 = Approx. 88%
#3 = Approx. 77%

Internal features include:

- 1 Enhanced twin-hammer impact mechanism
- 2 Supermotor™
- 3 Through-bolt construction
- 4 Corrode-X™ (Components impervious to corrosive contaminants)
- 5 Tilt throttle
- 6 Reverse or forward bias
- 7 Concentric cylinder design
- 8 Composite vanes
- 9 Balanced horizontal suspension bail (opt.)
- 10 Piped-away exhaust (opt.)

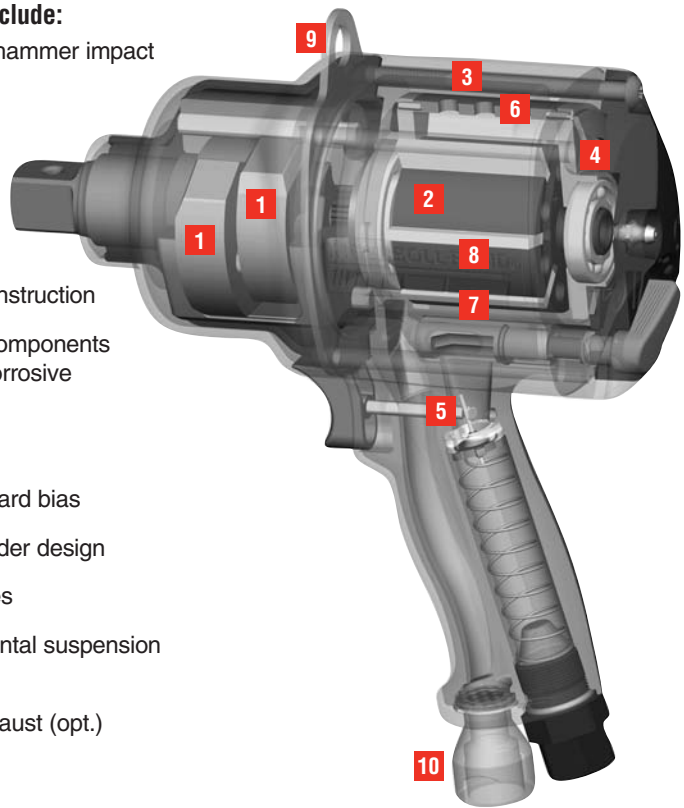

IR2161

The IR2161 models

The IR2161 heavy duty models are ideal for applications a little less demanding than those for the IR2925.

Features that distinguish the IR2161 from the IR2925 models include:



- Enhanced single-hammer mechanism
- Maximum torque of 1250 ft.-lbs.
- Smooth, high-gloss cast aluminum finish
- 6-Vane high-output air motor
- Smooth, contoured exterior profile

External features include:

- Ergonomic handle design
- Smooth contoured profile
- Three-piece housing
- Handle exhaust

- 360° swivel air inlet
- Contoured trigger
- Minimum side-to-center distance
- Enhanced pressure-feed lubrication system
- Three-position power regulation and forward/reverse control
Position #1 = Full
#2 = Approx. 88%
#3 = Approx. 77%
- Ribbed lever surface

Internal features include:

- An enhancement to the original single-hammer mechanism provides increased durability and performance (patent applied for)
- 6-Vane high-output air motor
- Through-bolt construction
- 360° swivel air inlet
- Tilt throttle
- Concentric cylinder design
- Balanced horizontal suspension bail (opt.)
- Piped-away exhaust (opt.)



IR2141P

The IR2141P delivers an exceptional blend of performance, control, and durability

TwinHammer Plus™ mechanism
(patent pending)

Ingersoll-Rand introduced the original twin hammer mechanism, and we've continually refined it for smooth, efficient power delivery...and now 30 percent greater durability.

Six-vane high-output air motor

High efficiency motor quickly delivers maximum torque.

Through bolt construction

Facilitates fast, easy maintenance. Eliminates sharp edges and protrusions on the housing.

4 power positions

Enables the operator to tailor the power output to the application.



1,200 ft.-lbs. of Pure Power

Best in class torque performance, and best in class power-to-weight ratio.

Contoured trigger

Provides a comfortable finger position for easy starts and smooth operation.

One hand operation forward/reverse buttons
(patented design)

Quick, easy directional changes

Durable and lightweight composite housing

Gives the operator the comfort, agility, access and control for the most demanding conditions.

Ergonomically designed handle for increased comfort

Provides a comfortable, secure grip and excellent control.

In-handle exhaust

Directs air away from the operator and the work.

360° swivel inlet
(patented design)

Helps eliminate air hose twisting and binding.



The new 2141P 3/4 -inch drive air impact wrench tackles the toughest jobs in the plant with a new level of productivity.

Air Impact Tools

3/4" Industrial Production Class

IR 2925P1Ti

3/4" Air Impact Wrench

Our flagship 3/4" industrial impact wrench, the 2925P1Ti has a titanium hammer case for even greater durability. It's built to provide optimal control and withstand the toughest operating conditions.

- Titanium hammer case
- Ergonomic handle design
- Three position power regulation
- Three-piece motor housing
- Model 2925RBP1Ti is reversed biased with 1600 ft-lbs max torque



IR 1720B1

3/4" Air Impact Wrench

The IR 1720B1 is our most popular 3/4" drive industrial impact wrench in a D handle configuration. Designed for applications not as durable as those for the 2925B2Ti, the 1720B1 is a tough, general purpose industrial impact tool for production or heavy maintenance use.

- 1,000 ft-lbs maximum torque
- Optional dead handle available
- Steel hammer case



IR 1720P1

3/4" Air Impact Wrench

The 1720P1 is designed for those applications that are not as demanding as those for the 2925P1Ti. A great general purpose industrial 3/4" impact wrench.

- Steel hammer case
- Built in lubricator
- B1 model; D handle design



IR 2141P

3/4" Air Impact Wrench

Weighing just 7 lbs and only 8.2" long, the 2141P is the smallest 3/4" impact on the market. The composite, ergonomic design is durable and comfortable and the 1200 ft-lbs of max torque will get the job done quickly.

- Twin Hammer Plus mechanism for smooth, efficient power
- High output, six vane motor
- Four position power regulator



Options Available

Models 2161P, 2171P

- Piped-away exhaust kit No. 2161-123
- Horizontal suspension bail No. 2161-366
- Boot 2161-P32

Series 2925

- Piped-away exhaust kit No. 2161-123
- Horizontal suspension bail No. 2161-366
- Number 4 spline anvil No. 2910-A526

Series 2920B

- 2910B-726-6: 6" extended 3/4" anvil
- Horizontal hanger No. 910-366
- 5/8" hex quick change anvil No. 2910B-A926-10
- Power regulator valve kit No. 2920-K32

Series 1720

- 3/4" drive x 6" (152 mm) hog ring style
- Extended anvil No. 265-A626-6
- Horizontal hanger No. 910-366
- Power regulator Kit No. 2920-K329
- Reverse valve Kit No. 1720-K329
- Dead handle 834-48
- Dead handle bracket 2910B-364

Series 2141P

- Piped-away exhaust kit
- Horizontal suspension bail
- Tool boot

Model	Drive Description	Handle	Free Speed rpm	Impacts per minute	Maximum Torque		Recomm. Torque Range		Weight, less socket		Length, less socket		Side to Center Distance		Size Hose Recomm. in. mm	cfm
					ft.-lb.	Nm	ft.-lb.	Nm	lb.	kg	in.	mm	in.	mm		
Super Duty Impact Tools																
2925P1Ti	3/4" square	Pistol	5200	1050	1450	1972	350-1100	476-1496	11 ⁷ / ₈	5.39	8 ⁷ / ₈	225	1 ³ / ₄	44	1/2 13	60
2925RBP1Ti	3/4" square Reverse Bias	Pistol	5200	1050	1600 R 1300 F	2176 1768	400-1400 300-950	544-1904 408-1292	11 ⁷ / ₈	5.39	8 ⁷ / ₈	225	1 ³ / ₄	44	1/2 13	60
2920B1	3/4" square	Grip	5000	950	1100	1495	250-800	339-1085	13 ³ / ₁₆	5.98	12 ¹ / ₂	318	1 ²⁹ / ₃₂	49	1/2 13	36
2920B9	3/4" sq. at 90°	Grip	5000	950	550	949	125-400	203-678	23 ¹¹ / ₁₆	10.75	17 ¹ / ₂	445	1 ¹⁵ / ₁₆	133	1/2 13	36
Heavy Duty Impact Tools																
2161P	3/4" square	Pistol	5750	1025	1250	1700	250-900	340-1224	11 ¹ / ₄	5.10	8 ¹ / ₂	216	1 ³ / ₄	44	1/2 13	55
1720P1	3/4" square	Pistol	5500	1000	1000	1360	200-600	271-813	11 ⁷ / ₈	5.39	7 ⁵ / ₈	194	1 ²⁹ / ₃₂	48	1/2 13	40
1720B1	3/4" square	Grip	5500	1000	1000	1360	200-600	271-813	13 ³ / ₁₆	6.27	11 ³ / ₄	299	1 ²⁹ / ₃₂	48	1/2 13	40
Standard Duty Impact Tools																
2141P	3/4" square	Pistol	7250	1175	1200R 1000F	1492 1492	200-900	271-1220	7.0	3.2	8.2	208	1 ³ / ₄	44	1/2 13	40
2141P3	#4 spline	Pistol	7250	1175	1200R 1000F	1492 1492	200-900	271-1220	7.0	3.2	8.2	208	1 ³ / ₄	44	1/2 13	40

Note: IR2925 number 4 spline models are available by converting the standard square drive anvil with number 4 spline anvil part number 2910-A526. The same performance figures apply.

Performance figures are at 90 psi (620 kPa) air pressure.

Angle head gear ratio on model 2920B9 is 2 to 1.

† Side to center distance of angle head. Height of angle head to shoulder of square drive is 3¹/₂" (89 mm).

**2920B9 Hammer Case is plated ductile iron.

◆ Approx. 50% torque reduction.

I.T.: Inside Throttle

O.T.: Outside Throttle

Air Impact Tools

3/4" Maintenance/Automotive Class*

IR252

3/4" Standard Duty

Air Impact Wrench

The IR252 is an economical standard duty 3/4" wrench for engine teardowns or general maintenance. This is a good lightweight 3/4" wrench with a high power rating for its compact size.

- Full power in reverse; 3-position adjustable power in forward
- 750 ft.-lbs. of torque
- Handle exhaust
- Integral 360 degree swivel inlet
- Lightweight and easy to operate
- Long, trouble-free life insured by oil bath lubrication



IR258

3/4" Heavy Duty

Air Impact Wrench

The IR258 delivers 1000 ft.-lbs. of maximum torque for work on trucks, heavy equipment, and agricultural machinery. It features an excellent power-to-weight ratio for ease of use, as well as a three-speed power regulator for tailoring output in forward and reverse.

- In-handle exhaust directs air flow away from the operator and the work
- 360 degree swivel inlet helps eliminate twisted hoses
- Fully adjustable power in forward and reverse



IR261

3/4" Super Duty

Air Impact Wrench

The highly-regarded IR261 model combines compact size with high output, which makes it perfect for everything from spring work to pinion nut and track pad removal and major engine teardowns.

- Jumbo hammer mechanism
- Up to 1,100 ft.-lbs. of torque
- Trouble-free, longer performance aided by the Pressure-Feed Lube System
- Compact and only 7-5/8" long
- Handle exhaust

For optional power regulator please order part #2920-K329



IR261-3

3/4" Super Duty Extended Anvil

Air Impact Wrench

Same specifications as the IR261-6 model, but with 3" extended anvil.

IR261-6

3/4" Super Duty Extended Anvil

Air Impact Wrench

A popular truck tire tool, this model includes all the high-performance features of the IR261. You'll be able to reach lug nuts in deep truck wheels easily with its 6" extended anvil. The tool itself is lightweight and very compact.



Model Number	Performance Rating	Maximum Torque ft.-lb. (Nm)	Free Spd. (rpm)	Weight lbs. (kg)	Length in. (mm)	Av. Air Consump. cfm (l/min)	@ Load cfm (l/min)	Sound dBA (Press./Power)	Air Inlet NPTF in.	Min. Hose Size in. (mm)
IR252	Standard Duty	750 (1,020)	6,500	8.6 (3.9)	9 (229)	7.5 (212)	28 (793)	92.1/105.1	3/8	1/2 (13)
IR258	Heavy Duty	1,000 (1,360)	6,200	10.77 (4.89)	9.8 (249)	8 (226)	30 (835)	93.7/106.7	3/8	1/2 (13)
IR261	Super Duty	1,100 (1,496)	5,500	12.4 (5.62)	8.8 (224)	9.5 (269)	38 (1076)	101.1/114.1	3/8	1/2 (13)
IR261-3	Super Duty Ext.Anv.	1,100 (1,496)	5,500	13 (5.90)	11.8 (300)	9.5 (269)	38 (1076)	101.1/114.1	3/8	1/2 (13)
IR261-6	Super Duty Ext.Anv.	1,100 (1,496)	5,500	13.7 (6.21)	14.8 (376)	9.5 (269)	38 (1076)	101.1/114.1	3/8	1/2 (13)

*Maintenance/Automotive class tools are designed for maintenance and automotive applications involving intermittent use.

IR2141

3/4" Ultra Duty

Air Impact Wrench

Power means productivity. With best-in-class torque, the 2141 delivers plenty of it in the smallest, lightest package available. Delivers best power-to-weight ratio and best size ratio in its class as well. Great maneuverability for tight, awkward spaces.

- Weighs just 7 lbs.
- Only 8.2" long
- 1200 ft.-lbs. maximum torque
- TwinHammer Plus™ mechanism for 30 percent greater durability
- Contoured professional touch trigger and ergonomically designed handle for increased comfort



IR2161XP

3/4" Ultra Duty

Air Impact Wrench



The IR2161 combines a six-vane high output air motor, through-bolt construction, ergonomic handle and housing design to create an impact tool that offers increased power and durability like no other.

- Most powerful 3/4" impact in the industry
- Maximum torque 1,250 ft.-lbs.
- Full power reverse
- 3-position power regulator
- 360 degree swivel inlet



IR2161XP-6

3/4" Ultra Duty

Air Impact Wrench



The IR2161-6 offers all of the ergonomic, power and durability enhancing features as the IR2161XP but with an extended anvil for those hard to reach applications.

- Jumbo Hammer mechanism
- Up to 1,250 ft.-lbs. of torque
- Trouble-free, longer performance aided by the Pressure-Feed Lube System
- Compact and only 7-5/8" long
- Handle exhaust



C28241-800

Ingersoll-Rand ARO Filter-Regulator-Lubricator (FRL)

Take care of your pneumatic equipment with Ingersoll-Rand ARO brand filters, regulators, and lubricators. Designed to clean, control and lubricate your air lines, ARO FRLs will make sure you get the most out of your tools. They are available in complete FRL packages, individual components, and in piggyback configurations, with a variety of air flows to choose from.



C28241-800 (Modular)

Model Number	Performance Rating	Maximum Torque ft.-lb. (Nm)	Free Spd. (rpm)	Weight lbs. (kg)	Length in. (mm)	Av. Air Consump. cfm (l/min)	@ Load cfm (l/min)	Sound dBA (Press./Power)	Air Inlet NPTF in.	Min. Hose Size in. (mm)
IR2141	Ultra Duty	1,200 (1,627)	7,250	7 (3.2)	8.2 (208)	9.5 (269)	40 (1133)	99	3/8	1/2 (13)
IR2161XP	Ultra Duty	1,250 (1,695)	6,000	11.8 (5.35)	8.5 (216)	10 (283)	46 (1303)	98/111	3/8	1/2 (13)
IR2161XP-6	Ultra Duty	1,250 (1,695)	6,000	13.1 (5.95)	14.5 (368)	10 (283)	46 (1303)	98/111	3/8	1/2 (13)

3/4" Square Drive

* Maintenance/Automotive class tools are designed for maintenance and automotive applications involving intermittent use.

Air Impact Tools

1" Industrial Production Class

IR 2940B2

1" Air Impact Wrench

The 2940B2 is our most popular 1" industrial impact wrench. Designed to withstand tough steel erection, power generation or petrochemical applications, the 2940B2's durability and power are legendary.

- Powder coated ductile iron hammer case
- Powder coated motor housing and handle
- Straight dead handle
- Two-piece motor housing
- Built in lubricator



IR 2940P2

3/4" Air Impact Wrench

Similar features and benefits as the 2940B2 but in a pistol grip design.

- Spade style dead handle
- Integral power regulator



Options Available

Series 2940

- Piped-away exhaust muffler kit
No. 2940-KM184 (A & B models only)
- Horizontal hanger consisting of
 - One horizontal hanger No. 2934-366
 - Two hanger spacers No. 2934-140
 - *1" drive x 6" (152 mm) extended anvil No. 2940-314-6

Model	Drive Description	Handle	Free Speed rpm	Impacts per minute	Maximum Torque		Recomm. Torque Range		Weight, less socket		Length, less socket		Side to Center Distance in. mm	Size Hose Recomm. in. mm	cfm
					ft.-lb.	Nm	ft.-lb.	Nm	lb.	kg	in.	mm			

Super Duty Impact Tools

2940A1**	No. 5 spline	Grip O.T.	5000	850	2000	2710	1000-1600	1360-2170	22	9.98	12 ¹ / ₄	311	2 ³ / ₁₆	56	3/4 19	58
2940A2	1" square	Grip O.T.	5000	850	2000	2710	1000-1600	1360-2170	22	9.98	12 ¹ / ₄	311	2 ³ / ₁₆	56	3/4 19	58
2940B1**	No. 5 spline	Grip I.T.	5000	850	2000	2710	1000-1600	1360-2170	22	9.98	12 ¹ / ₄	311	2 ³ / ₁₆	56	3/4 19	58
2940B2	1" square	Grip I.T.	5000	850	2000	2710	1000-1600	1360-2170	22	9.98	12 ¹ / ₄	311	2 ³ / ₁₆	56	3/4 19	58
2940P2	1" square	Pistol	4000	810	2000	2710	1000-1600	1360-2170	22 ⁷ / ₈	10.4	9 ⁷ / ₈	251	2 ³ / ₁₆	56	3/4 19	58

*Approx. 15% torque reduction.

**No. 5 spline 1³/₈" OD 14 teeth.

Performance figures are at 90 psi (620 kPa) air pressure.

O.T.: Outside Trigger

I.T.: Inside Trigger

IR 2934B9

1" Air Impact Wrench

The 2934B9 has a 90° angle head for vertical applications. Powerful twin hammer design and spade handle come standard.

- Powder coated ductile iron hammer case
- Powder coated motor housing and handle
- Spade style handle
- Two-piece motor housing
- Integral muffler



IR 2934P2

1" Air Impact Wrench

Ingersoll-Rand's 2934P2 is a 1" pistol grip impact wrench built for tough applications and weighs under 9lbs.

- Powder coated ductile iron hammer case
- Powder coated motor housing and handle
- Spade style handle
- Two-piece motor housing
- Built in power regulator



Options Available

Series 1734

- No. 5 spline 280-A514-6
- *6" square anvil: 280-726-6
- Hanger: 2934-366
- Exhaust deflector kit: 2934-K23
- Piped-away exhaust with muffler: 2940-KM184
- Piped-away exhaust without muffler: 2940-K184

IR 1712B2

1" Air Impact Wrench

One of our more popular 1" industrial impact wrenches, the 1712B2 puts out 1350 ft-lbs max torque and weighs just over 11 lbs.

- Ductile iron hammer case
- Powder coated motor housing and handle
- Two-piece motor housing
- Inside throttle and spade style dead handle



Series 2934

- 90° Angle drive is available for all square drive models.
- Order angle attachment No. 2934A90 and hex nose hammer case No. 2934-A827. This hammer case must be used to replace the standard hammer case. Note that these items are furnished as standard equipment on Model 2934B9

- *1" drive x 6" (152 mm) extended anvil No. 2934-314-6
- Horizontal hanger consisting of:
 - One horizontal hanger No. 2934-366
 - Two hanger spacers No. 2934-140
- Piped-away exhaust muffler kit No. 2940-KM184. (A & B models only)

Series 1712

- *1" drive x 6" (152 mm) extended anvil No. 280-726-6
- 2934-366 horizontal hanger

Model	Drive Description	Handle	Free Speed rpm	Impacts per minute	Maximum Torque ft.-lb.	Maximum Torque Nm	Recomm. Torque Range ft.-lb.	Recomm. Torque Range Nm	Weight, less socket lb.	Weight, less socket kg	Length, less socket in.	Length, less socket mm	Side to Center Distance in.	Side to Center Distance mm	Size Hose Recomm. in.	Size Hose Recomm. mm	cfm
-------	-------------------	--------	----------------	--------------------	------------------------	-------------------	------------------------------	-------------------------	-------------------------	------------------------	-------------------------	------------------------	-----------------------------	----------------------------	-----------------------	----------------------	-----

Super Duty Impact Tools

2934A2	1" square	Grip O.T.	6600	750	1500	2030	500-1100	678-1490	18 1/2	8.39	11 1/4	286	2 3/16	56	3/4	19	47
2934B1**	No. 5 spline	Grip I.T.	6600	750	1500	2030	500-1100	678-1490	18 1/2	8.39	11 1/4	286	2 3/16	56	3/4	19	47
2934B2	1" square	Grip I.T.	6600	750	1500	2030	500-1100	678-1490	18 1/2	8.39	11 1/4	286	2 3/16	56	3/4	19	47
2934B9	1" sq. at 90°	Grip I.T.	5300	780	750	1624	250-500	678-1355	35 3/4	16.2	18 5/8	473	1 15/8	141	3/4	19	47
2934P2	1" square	Pistol	5300	825	1500	2030	500-1100	678-1490	20	9.07	8 5/8	219	2 3/16	56	3/4	19	47

Heavy Duty Impact Tools

1734A1**	No. 5 spline	Grip O.T.	6000	800	1400	1904	450-1000	612-1860	18 3/8	8.34	11 1/4	286	2 3/16	56	3/4	19	47
1712B2	1" square	Grip I.T.	6000	800	1350	1836	450-1000	612-1860	18 1/4	8.28	11 1/4	286	2 3/16	56	3/4	19	47
1712P2	1" square	Pistol	6000	800	1350	1836	450-1000	612-1860	18 1/4	8.28	11 1/4	286	2 3/16	56	3/4	19	56

*Approx. 15% torque reduction.

Performance figures are at 90 psi (620 kPa) air pressure. Angle head gear ratio on model 2934B9 B is 1 to 1.

**No. 5 spline 1 5/8" OD 14 teeth.

† Side to center distance of angle head. Height of angle head to shoulder of square drive is 4 3/8" (111 mm).

I.T.: Inside Trigger

O.T.: Outside Trigger

Air Impact Tools

1" Industrial Production Class

IR 2925P3Ti

1" Air Impact Wrench

The IR 2925P3Ti has the same features and benefits as the 3/4" 2925P1Ti but with a 1" anvil.

- Titanium hammer case
- Ergonomic handle design
- Three position power regulation
- Three-piece motor housing



IR 2925RB2Ti

1" Air Impact Wrench

Similar in design to the 3/4" 2925RB1Ti but with more power, the 2925RB2Ti is reverse biased and puts out 1700 ft-lbs.

- Titanium hammer case
- Ergonomic D shaped handle design
- Three position power regulation
- Corrosion resistant component package



IR 2171P

1" Air Impact Wrench

With a six vane high output motor, through bolt construction and ergonomic design, the 2171P offers great features and power and an economical price.

- 1250 ft-lbs. max torque
- 3-position power regulator
- 360° swivel inlet
- Steel hammer case



IR 1720P3

1" Air Impact Wrench

The 1720P3 puts out 1100 ft-lbs. max torque and is a good choice for light industrial applications that are not as demanding as those for the 2925 series, such as industrial maintenance.

- Steel hammer case
- B3 model; inside throttle and dead handle



Options Available

Models 2161P, 2171P

- Piped-away exhaust kit No. 2161-123
- Horizontal suspension bail No. 2161-366
- Boot 2161-P32

Series 2925

- Piped-away exhaust kit No. 2161-123
- Horizontal suspension bail No. 2161-366
- Number 4 spline anvil No. 2910-A526

Series 2920B

- 2910B-726-6: 6" extended 3/4" anvil
- Horizontal hanger No. 910-366
- 5/8" hex quick change anvil No. 2910B-A926-10
- Power regulator valve kit No. 2920-K32

Series 1720

- 3/4" drive x 6" (152 mm) hog ring style
- Extended anvil No. 265-A626-6
- Horizontal hanger No. 910-366
- Power regulator Kit No. 2920-K329
- Reverse valve Kit No. 1720-K329
- Dead handle 834-48
- Dead handle bracket 2910B-364

Model	Drive Description	Handle	Free Speed rpm	Impacts per minute	Maximum Torque		Recomm. Torque Range		Weight, less socket		Length, less socket		Side to Center Distance in. mm	Size Hose Recomm. in. mm	cfm
					ft.-lb.	Nm	ft.-lb.	Nm	lb.	kg	in.	mm			

Super Duty Impact Tools

2925P3Ti	1" square	Pistol	5200	1050	1450	1972	350-1100	476-1496	11 ⁷ / ₈	5.39	8 ⁷ / ₈	225	1 ³ / ₄	44	1/2 13	60
2925B2Ti	1" square	Grip	6500	900	1600	2170	350-1400	475-1904	14	6.35	12 ⁵ / ₈	314	1 ⁵ / ₈	41	1 1/2 13	60
2925RB2Ti	1" square Reverse Bias	Grip I.T.	6500	900	1700R 1500F	2305 2034	F300-1300 R400-1500	407-1763 544-2034	14	6.35	12 ⁵ / ₈	314	1 ⁵ / ₈	41	1 1/2 13	60
2925RBP3Ti	1" square Reverse Bias	Pistol	5200	1050	1600 R 1300 F	2176 1768	400-1400 300-950	544-1904 408-1292	11 ⁷ / ₈	5.39	8 ⁷ / ₈	225	1 ³ / ₄	44	1/2 13	60
2920B3	1" square	Grip	5000	950	1100	1495	250-800	339-1085	13 ³ / ₁₆	5.98	12 ¹ / ₂	318	1 ²⁹ / ₃₂	49	1/2 13	36

Heavy Duty Impact Tools

2171P	1" square	Pistol	5750	1025	1250	1700	250-900	340-1224	11 ¹ / ₄	5.10	8 ¹ / ₂	216	1 ³ / ₄	44	1/2 13	55
1720P3	1" square	Pistol	5500	1000	1100	1490	250-750	340-1016	11 ⁷ / ₈	5.39	7 ⁵ / ₈	194	1 ²⁹ / ₃₂	48	1/2 13	40
1720B3	1" square	Grip	5500	1000	1100	1490	250-750	340-1016	13 ³ / ₁₆	6.27	11 ³ / ₄	299	1 ²⁹ / ₃₂	48	1/2 13	40

IR271

1" Super Duty

Air Impact Wrench

The shortest 1" drive air impact wrench is also one of the most powerful. It combines a very compact size with high power output, making it ideal for tire changing, spring work, pinion nut and tractor pad removal, and shock work.

- Impressive power-to-size ratio
- Up to 1,100 ft.-lbs. of torque
- Pressure-Feed Lube System for longer service life
- Dead handle improves operator control



IR280

1" Super Duty

Air Impact Wrench

Here's the ultimate in quality, the 1" drive wrench with 1,600 ft.-lbs. torque to handle tough jobs in cramped spaces.

- Built-in Pressure-Feed Lube System
- The side handle adjusts to suit you
- Built-in oil reservoir provides continuous misting of the air motor



IR280-6

1" Super Duty Extended Anvil

Air Impact Wrench

High production truck tire changing requires the brute force only the Jumbo Hammer Impact mechanism delivers. Reach into deep truck wheels easily with the 6" extended anvil wrench, designed for high production truck tire changing.



IR280-S6

#5 Spline Super Duty Extended Anvil

Air Impact Wrench

A standard 6" extended #5 spline drive anvil gives you additional flexibility for certain high production truck tire changing jobs, plus all the power of the rest of the IR280 wrenches.

Lubricants and Greases

Proper lubrication of air tools is a must to prevent excessive wear of moving parts: to prevent possible rust and corrosion of bare, unprotected surfaces; and to provide smooth operation of motors and impact mechanisms. The Ingersoll-Rand full line of oils and greases has been tested thoroughly and is recommended without reservation.



Model 10P Air Line Lubrication



Model 105-LBK1 Air Care Kit

Model Number	Performance Rating	Maximum Torque ft.-lb. (Nm)	Free Spd. (rpm)	Weight lbs. (kg)	Length in. (mm)	Av. Air Consump. cfm (l/min)	@ Load cfm (l/min)	Sound dBA (Press./Power)	Air Inlet NPTF in.	Min. Hose Size in. (mm)
IR271	Super Duty	1,100 (1,496)	5,500	12.5 (5.67)	8.9 (226)	9.5 (269)	39 (1104)	101.1/114.1	3/8	1/2 (13)
IR280	Super Duty	1,600 (2,176)	6,000	22 (9.98)	13 (330)	10 (283)	55 (1557)	109.1/122.1	1/2	1/2 (13)
IR280-6	Super Duty Ext.Anv.	1,600 (2,176)	6,000	23.8 (10.80)	18.5 (470)	10 (283)	55 (1557)	109.1/122.1	1/2	1/2 (13)
IR280-S6	#5 Spline SD.Ext.Anv.	1,600 (2,176)	6,000	23.8 (10.80)	18.5 (470)	10 (283)	55 (1557)	109.1/122.1	1/2	1/2 (13)

*Maintenance/Automotive class tools are designed for maintenance and automotive applications involving intermittent use.

Air Impact Tools

1" Maintenance/Automotive Class*

IR285A

1" Heavy Duty

Air Impact Wrench

The IR285A model combines exceptional power, durability, and operator convenience. It delivers 1,450 ft.-lbs. of maximum torque, with a 5,000 rpm free speed and high efficiency, 6-vane motor. The integral 360 degree swivel inlet makes kinked hoses a thing of the past, and along with the swept-back side handle, provides excellent maneuverability.

- 1,450 ft.-lbs. maximum torque
- Superior balance; "angled-down" exhaust
- High efficiency 6-vane air motor
- Three-position power regulator



IR285A-6

1" Heavy Duty Extended Anvil

Air Impact Wrench

The same quality features of the IR285 with a standard 6" extended anvil.

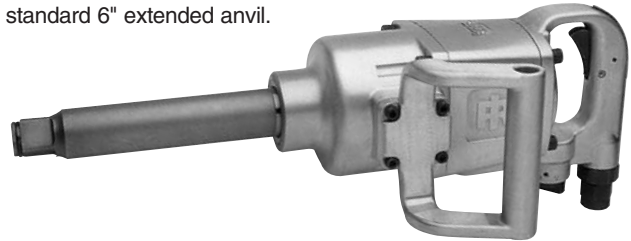

IR285A-S6

#5 Spline Heavy Duty Extended Anvil

Air Impact Wrench

A standard 6" extended #5 spline drive anvil and the other quality features of the IR285. The extended anvil makes these tools perfect for the demanding world of truck tire service.

IR290

1" Super Duty

Air Impact Wrench

Designed for getting into cramped spaces with big power, the IR290 has a three-way adjustable handle. It's a good choice for spring work, tractor pads, bus maintenance, and off-road and farm equipment.

- Up to 1,600 ft.-lbs. of torque
- Pressure-Feed Lube System for long life
- Adjustable side handle for better control.

For optional thread on muffler order part #2910-674



IR290-S

#5 Spline Super Duty

Air Impact Wrench

You get a standard #5 short spline drive anvil and the same quality features as the IR290.

IR293

1" Super Duty

Air Impact Wrench

This is the most powerful 1" wrench for spring work, tractor pads, bus maintenance, and off-road and farm equipment work. The built-in Pressure-Feed Lube System protects the unique Twin Hammer Impact mechanism as it delivers the ultimate in power.

- Up to 2,000 ft.-lbs. of torque
- Most powerful 1" wrench
- Long-lasting tool
- Handle exhaust



IR293-S

#5 Spline Super Duty

Air Impact Wrench

Ultimate power and all the other advantages of the IR293 are built into this tool along with a standard #5 short spline drive anvil.

Model Number	Performance Rating	Maximum Torque ft.-lb. (Nm)	Free Spd. (rpm)	Weight lbs. (kg)	Length in. (mm)	Av. Air Consump. cfm (l/min)	@ Load cfm (l/min)	Sound dBA (Press./Power)	Air Inlet NPTF in.	Min. Hose Size in. (mm)
--------------	--------------------	--------------------------------	--------------------	---------------------	--------------------	---------------------------------	-----------------------	--------------------------------	--------------------------	-------------------------------

1" Square Drive

IR285A	Heavy Duty	1,450 (1,972)	5,000	22 (9.98)	13.2 (335)	10 (283)	37 (1047)	107/120	1/2	1/2 (13)
IR285A-6	Hvy.Dty.Ext.Anv.	1,450 (1,972)	5,000	25.2 (11.43)	20.1 (511)	10 (283)	37 (1047)	107/120	1/2	1/2 (13)
IR285A-S6	#5Sp.HD.Ext.Anv.	1,450 (1,972)	5,000	25.2 (11.43)	20.1 (511)	10 (283)	37 (1047)	107/120	1/2	1/2 (13)
IR290	Spr.Dty.	1,600 (2,176)	6,000	21.9 (9.93)	9.75 (248)	10 (283)	60 (1699)	104.6/117.6	1/2	1/2 (13)
IR290-S	#5Sp.Spr.Dty.	1,600 (2,176)	6,000	21.9 (9.93)	10 (254)	10 (283)	60 (1699)	104.6/117.6	1/2	1/2 (13)
IR293	Spr.Dty.	2,000 (2,720)	3,500	22.8 (10.34)	11.3 (287)	12 (340)	64 (1812)	90.3/103.3	1/2	1/2 (13)
IR293-S	#5Sp.Spr.Dty.	2,000 (2,720)	3,500	22.8 (10.34)	11.3 (287)	12 (340)	64 (1812)	90.3/103.3	1/2	1/2 (13)

IR295

1" Heavy Duty

Air Impact Wrench

A new, improved 1" drive tool perfect for truck and heavy equipment maintenance, the IR295 offers power and convenience at an affordable price. It's compact and lightweight, and perfect for working on suspension components, tractor pads, and other big capacity general repair functions.

- Handle exhaust directs air away from the work
- Top-mounted dead handle
- 3-position power regulator provides torque management



IR295-S

#5 Spline 1" Heavy Duty

Air Impact Wrench

The IR295-S offers all the features and benefits of the IR295, but with a standard #5 short spline drive anvil.

IR2190Ti

1" Titanium Duty Air Impact Wrench

The newest member on the Titanium Team. Designed specifically for tire changing, the chainsaw handle provides comfortable control for the operator. The Titanium IR2190Ti delivers devastating torque in a lightweight package.

- Titanium Hammer Case provides super strength with reduced weight
- Narrow Hammer case provides better access to the wheel well
- Chainsaw handle for enhanced ergonomic operation
- Durable anvil bushing for extended life
- Roll cage inlet design protects the tool during extreme use



IR2190Ti-6

1" Titanium Duty Air Impact Wrench Extended Anvil

Same specifications as the 2190Ti with a 6" extended anvil.

IR2190DTi-6

1" Titanium Duty

Air Impact Wrench

A traditional "D" handle coupled with the features and benefits of the Titanium 2190Ti-6



IR2171XP

1" Ultra Duty

Air Impact Wrench

The new IR2171 combines a six-vane high output air motor, through-bolt construction, ergonomic handle and housing design to create an impact tool that offers increased power and durability like no other.

- High power-to-weight ratio
- Maximum torque 1,250 ft.-lbs.
- Full power reverse
- 3-position power regulator
- 360 degree swivel inlet



Model Number	Performance Rating	Maximum Torque ft.-lb. (Nm)	Free Spd. (rpm)	Weight lbs. (kg)	Length in. (mm)	Av. Air Consump. cfm (l/min)	@ Load cfm (l/min)	Sound dBA (Press./Power)	Air Inlet NPTF in.	Min. Hose Size in. (mm)
IR295	Heavy Duty	1,450 (1,972)	5,000	22 (9.98)	10.5 (267)	10 (283)	37 (1047)	N/A	3/8	1/2 (13)
IR295-S	#5 Spline Heavy Duty	1,450 (1,972)	5,000	21.18 (9.61)	10.5 (267)	10 (283)	37 (1047)	N/A	3/8	1/2 (13)
IR2190Ti	Titanium Duty	1,650 (2,238)	6,800	14 (6.4)	15.38 (391)	12 (336)	58 (1624)	103.8/116.8	1/2	1/2 (13)
IR2190Ti-6	Titanium Duty	1,650 (2,238)	6,800	16 (7.3)	21.48 (546)	12 (336)	58 (1624)	103.8/116.8	1/2	1/2 (13)
IR2190DTi-6	Titanium Duty	1,650 (2,238)	6,800	16 (7.3)	21.48 (546)	12 (336)	58 (1624)	103.8/116.8	1/2	1/2 (13)
IR2171XP	Ultra Duty	1,250 (1,695)	6,000	13.1 (5.95)	12.5 (318)	10 (282)	46 (1303)	98/111	1/2	1/2 (13)

*Maintenance/Automotive class tools are designed for maintenance and automotive applications involving intermittent use.

Air Impact Tools

Impact Tool Selection Guide

This chart will assist you in recommending a particular Impact Tool for a specific application. The figures used are based on 70% of the tension proof load of a given size and grade bolt. For example, a Grade 5 bolt has a proof load of 94,200 psi (649,509 kPa). A 1/2"-13 UNC Grade 5 bolt has a tensile stress area — the cross section at the root of the thread — of 0.1282 in.² (82.7 mm²). So therefore it has an actual proof load of 12,076 lbs. (53,715 newtons). 70% of this proof load is 8453 lbs. (14,523 newtons). By looking at the chart, we find that in order to put 8450 lbs. (37,586 newtons) of tension on the 1/2" (13 mm) UNC Grade 5 bolt, we must apply 70 ft.-lbs. (94.9 Nm) torque. To do this, we recommend the Series 2906 Impact Tool.

It should be remembered that 70% of the proof load is normally the amount of tension needed to assure a properly tightened joint.

Bolt Grade	Bolt Diameter, in.		1/4	5/16	3/8	7/16	1/2	9/16	5/8	3/4	7/8	1	1 1/8	1 1/4
	Bolt Diameter, mm		6	8	10	11	13	14	16	19	22	25	29	32
	Hex Size, Max.		1/2	19/32	11/16	25/32	7/8	31/32	11/16	1 1/4	17/16	1 5/8	1 13/16	2
	Inches, Min.		3/8	15/32	9/16	21/32	3/4	27/32	15/16	1 1/8	1 5/16	1 1/2	1 11/16	1 7/8
Grade 1	Torque	ft.-lbs.	3	6	11	18	28	43	55	97	155	230	340	480
		Nm	4.07	8.14	14.9	24.4	38	58.3	74.6	132	210	312	461	651
	Impact Tool Recommended					2902	2903	2903	2903	2906	2906	2161	2161	2925
	Tension	lbs.	730	1,210	1,800	2,460	3,280	4,200	5,200	7,000	10,600	14,000	18,200	23,000
		kN	3.24	5.38	8.01	10.9	14.6	18.7	23.1	31.1	47.1	62.3	80.9	102
Grade 5	Torque	ft.-lbs.	8	16	28	46	70	110	140	250	405	600	770	1,080
		Nm	10.8	21.7	38	62.4	95	149	190	339	549	814	1,044	1,464
	Impact Tool Recommended				2902	2903	2903	2906	2906	2161	2161	2925	2934	2934
	Tension	lbs.	1,900	3,100	4,600	6,350	8,450	10,900	13,500	20,000	27,400	36,000	41,000	52,000
		kN	8.4	13.8	20.4	28.2	37.6	48.5	60	89	122	160	182	231
ASTM-A325	Torque	ft.-lbs.						200	355	570	850	1,060	1,495	
		Nm						271	481	773	1,153	1,437	2,027	
	Impact Tool Recommended							2906	2161	2925	2934	2940	2940	
	Tension	lbs.						19,000	28,000	39,000	51,000	56,000	71,000	
		kN						44.5	124	173	227	249	316	
Grade BB ASTM-A354	Torque	ft.-lbs.	8	15	27	43	66	106	131	234	376	565	830	1,170
		Nm	10.8	20.3	36.6	58.3	89.5	144	178	317	510	766	1,125	1,586
	Impact Tool Recommended				2902	2903	2903	2906	2906	2161	2161	2925	2934	2940
	Tension	lbs.	1,780	2,930	4,340	5,950	7,950	10,190	12,660	18,700	25,870	33,940	44,240	56,000
		kN	7.9	13	19.3	26.5	35.4	45.3	56.3	83.1	115	151	196	249
Grade BC ASTM-A354	Torque	ft.-lbs.	10	20	35	56	86	138	173	306	495	742	1,090	1,530
		Nm	13.6	27.1	47.5	75.9	117	187	234	415	671	1,006	1,478	2,075
	Impact Tool Recommended				2902	2903	2903	2906	2906	2161	2161	2925	2934	2940
	Tension	lbs.	2,340	3,850	5,700	7,815	10,430	13,380	16,610	24,550	33,960	44,550	58,070	73,500
		kN	10.4	17.1	25.3	34.8	46.4	59.5	74	109	151	198	258	327
Grade 8 ASTM-A354	Torque	ft.-lbs.	11	23	40	65	99	159	198	350	566	848	1,245	1,750
		Nm	14.9	31.2	54.2	88.1	134	216	268	475	767	1,150	1,688	2,373
Grade BD	Impact Tool Recommended			2902	2903	2903	2906	2906	2161	2925	2934	2934	2940	2950
	Tension	lbs.	2,740	4,400	6,510	8,930	11,920	15,290	18,980	28,050	38,800	50,900	66,360	84,000
		kN	12.2	19.6	28.9	39.7	53	68	84.4	125	172	226	295	374
ASTM-A490	Torque	ft.-lbs.						250	435	715	1,070	1,580	2,125	
		Nm						339	590	970	1,451	2,142	2,882	
	Impact Tool Recommended							2161	2925	2934	2940	2945	2950	
	Tension	lbs.						24,000	35,000	49,000	64,000	80,000	102,000	
		kN						107	156	218	285	356	454	

Air Impact Tools

Impact Tool Selection Guide



Only certain Impact Tools are shown in this chart. Compare the required torque shown in this chart with torque range figures shown in the Impact Tool specifications tables to select other suitable tools.

Bolt Grade	Bolt Diameter, in.	1 ³ / ₈	1 ¹ / ₂	1 ⁵ / ₈	1 ³ / ₄	2	2 ¹ / ₄	2 ¹ / ₂	2 ³ / ₄	3	3 ¹ / ₄	3 ¹ / ₂	3 ³ / ₄	4	
	Bolt Diameter, mm	35	38	41	44	51	57	64	70	76	83	89	95	102	
	Hex Size, Max. Inches	2 ³ / ₁₆	2 ³ / ₈	2 ⁹ / ₁₆	2 ³ / ₄	3 ¹ / ₈	3 ³ / ₈	3 ⁷ / ₈	4 ¹ / ₄	4 ⁵ / ₈	5	5 ³ / ₈	5 ³ / ₄	6 ¹ / ₈	
	Inches	Min. 2 ¹ / ₈	2 ¹ / ₄	2 ⁷ / ₁₆	2 ⁵ / ₈	3	3 ¹ / ₂	3 ³ / ₄	4 ¹ / ₈	4 ¹ / ₂	4 ⁷ / ₈	5 ¹ / ₄	5 ⁵ / ₈	6	
Grade 1	Torque	ft.-lbs.	660	860											
		Nm	895	1,166											
	Impact Tool Recommended		2925	2934											
	Tension	lbs.	28,400	34,600											
		kN	126	154											
Grade 5	Torque	ft.-lbs.	1,470	1,950											
		Nm	1,933	2,644											
	Impact Tool Recommended		2940	2950											
	Tension	lbs.	64,000	77,000											
		kN	285	342											
ASTM-A325	Torque	ft.-lbs.	1,960	2,600											
		Nm	2,658	3,526											
	Impact Tool Recommended		2950	5980	These bolts are used on structural steel applications. Torque and tension values are based on running the nut beyond the proof load of the bolt by the turn of the nut method. For detailed information consult the bolt manufacturer.										
	Tension	lbs.	85,000	103,000											
		kN	378	458											
Grade BB ASTM-A354	Torque	ft.-lbs.	1,580	2,080	2,700	3,400	5,150	7,500	10,300	13,100	17,100	21,800	27,500	34,000	41,300
		Nm	2,142	2,820	3,661	4,610	6,983	10,170	13,967	17,764	23,188	29,561	37,290	46,104	56,003
	Impact Tool Recommended		2945	2950	5980	5980	5982	5982	588	588	588	599	599	599	599
	Tension	lbs.	69,050	83,550	99,680	116,480	155,120	199,360	248,640	285,080	341,780	403,725	470,400	542,850	620,025
		kN	307	371	443	518	690	887	1,106	1,268	1,520	1,796	2,092	2,414	2,758
Grade BC ASTM-A354	Torque	ft.-lbs.	2,075	2,440	3,545	4,465	6,785	9,815	13,600	16,550	21,645	27,700	34,760	42,980	52,360
		Nm	2,814	3,309	4,807	6,054	9,200	13,309	18,442	22,442	29,351	37,561	47,134	58,281	71,000
	Impact Tool Recommended		2950	5980	5980	5980	5982	5982	588	588	588	599	599	599	599
	Tension	lbs.	90,630	109,620	130,830	152,880	203,950	261,660	326,340	361,100	432,910	517,690	595,840	687,610	787,370
		kN	403	488	582	680	907	1,164	1,452	1,606	1,926	2,303	2,650	3,058	3,493
Grade 8 ASTM-A354	Torque	ft.-lbs.	2,375	3,135											
		Nm	3,220	4,251											
Grade BD	Impact Tool Recommended		2950	5980											
	Tension	lbs.	103,570	125,330											
		kN	461	557											
ASTM-A490	Torque	ft.-lbs.	2,780	3,700											
		Nm	3,770	5,017											
	Impact Tool Recommended		5980	5980	These bolts are used on structural steel applications. Torque and tension values are based on running the nut beyond the proof load of the bolt by the turn of the nut method. For detailed information consult the bolt manufacturer.										
	Tension	lbs.	121,000	148,000											
		kN	538	658											

Air Impact Tools

Torque Control Impact Tools

IR Torque Control Impact Tools are designed for applications requiring fastener tightening control. The tools shut off automatically when preset torque levels are reached. Depending upon the model, built-in or detachable torsion bars sense torque levels, and signal a mechanical shut-off device to prevent over-torquing. These tools combine a ball and cam impact mechanism with a heavy-walled aluminum hammer case for maximum strength, minimum weight.





Options & Accessories

Series 5020T and Model 5020TDQ

- Torque setting clamp No. 5020T-951 (for Series 5020T only)
- Horizontal hanger:
 - One horizontal hanger No. 5020-366
 - includes spacers & screws
 - Two horizontal hanger spacers No. 504-140
 - Two horizontal hanger cap screws No. 504-376A
- Vertical hanger No. 5020-365

Series 5040T and Model 5040TDQ

- Vise-type torque setting jig No. 5040T-A951 (for Series 5040T only)
- Horizontal hanger:
 - One horizontal hanger No. 5040-366. Includes the following; Two horizontal hanger spacers No. 504-140 and two horizontal hanger cap screws No. 504-376A
- Vertical hanger No. 5040-365



Model	Drive Description	Torque Range		Type Torsion Bar	Free Speed rpm	Impacts per minute	Weight		Length		Side to Center Distance		cfm
		ft.-lb.	Nm				lb.	kg	in.	mm	in.	mm	
5020TAL1	3/8" square	6-17	8-23	AB	1400	2100	4	1.81	9	229	1 1/16	27	10
5020TAH1	3/8" square	10-30	13-40	AB	1400	2100	4	1.81	9	229	1 1/16	27	10
5020TDQ	7/16" hex Q.C.	10-30	13-40	NAD	1400	2100	4 3/16	1.9	11	279	1 1/16	27	10
5040TAL1	1/2" square	20-45	27-61	AB	1500	2150	6 1/4	2.84	10 1/2	267	1 3/8	35	15
5040TAM1	1/2" square	40-65	54-88	AB	1500	2150	6 1/4	2.84	10 1/2	267	1 3/8	35	15
5040TAH1	1/2" square	60-90	81-122	AB	1500	2150	6 1/4	2.84	10 1/2	267	1 3/8	35	15
5040TDQ	7/16" hex Q.C.	20-90	27-122	NAD	1500	2150	6 7/8	3.12	13 3/4	349	1 3/8	35	15

All of the above square drive Impact Tools are furnished with pin-type retainer.

Series 5020 and 5040 Impact Tools have 1/4" NPT air inlet: 1/4" (6 mm) size hose is recommended.

Performance figures are at 90 psi (620 kPa) air pressure.

AB = Adjustable, Built-in torsion bar. NAD = Non-adjustable, Detachable torsion bar.

Weights shown are with torsion bar, less socket. Weights of models with detachable torsion bars are with heaviest torsion bars. Lengths shown are with torsion bar, less socket.

Models ending in L1 are equipped with light torsion bar.

Models ending in M1 are equipped with medium torsion bar.

Models ending in H1 are equipped with heavy torsion bar.

Air Impact Tools

Torque Control Impact Tools

Non-adjustable Detachable Torsion Bars and Kits for Models 5020TDQ and 5040TDQ

- No. 5040TDQ-KP637 torsion bar kit (consists of one each non-adjustable torsion bar with pin-type retainer and No. 5040TDQ-637 torsion bar case)

- No. 5040TDQ-KB637 torsion bar kit (consists of one each non-adjustable torsion bar with ball-type retainer and No. 5040TDQ-637 torsion bar case)

Torsion Bar Number		Model 5020TDQ		Model 5040TDQ		Color Code
With 1/2" Square Drive Pin-Type Retainer	With 1/2" Square Drive Ball-Type Retainer	Torque Range ft.-lb.	Torque Range Nm	Torque Range ft.-lb.	Torque Range Nm	
5040TDQ-P535-1	5040TDQ-B535-1	6-10	8.14-13.6	20-25	27.1-33.9	Red
5040TDQ-P535-2	5040TDQ-B535-2	8-12	10.8-16.3	22-30	29.8-40.7	Orange
5040TDQ-P535-3	5040TDQ-B535-3	10-14	13.6-19	25-35	33.9-47.5	Yellow
5040TDQ-P535-4	5040TDQ-B535-4	12-16	16.3-21.7	30-40	40.7-54.2	Green
5040TDQ-P535-5	5040TDQ-B535-5	14-18	19-24.4	35-45	47.5-61.0	Blue
5040TDQ-P535-6	5040TDQ-B535-6	16-20	16.3-27.1	40-50	54.2-67.8	Violet
5040TDQ-P535-7	5040TDQ-B535-7	18-22	24.4-29.8	45-55	61.0-74.6	Red
5040TDQ-P535-8	5040TDQ-B535-8	20-24	27.1-32.5	50-60	67.8-81.4	Orange
5040TDQ-P535-9	5040TDQ-B535-9	22-26	29.8-35.2	55-65	74.6-88.1	Yellow
5040TDQ-P535-10	5040TDQ-B535-10	24-28	32.5-38	60-75	81.3-101	Green
5040TDQ-P535-11	5040TDQ-B535-11	26-29	35.2-39.3	70-85	94.9-115	Violet
5040TDQ-P535-12	5040TDQ-B535-12	27-30	36.6-40.7	75-90	102-122	Blue

Torque Control Impact Tool Operation

The Torque Control Impact Tool converts the torque of the air motor into powerful rotary impacts when a certain resistance to turning is met. The Ingersoll-Rand principle of compressing a sturdy hammer spring and suddenly releasing this energy to strike a powerful rotary blow makes it possible to quickly and efficiently run fasteners.

The Torque Control Impact Tool also incorporates a torsion bar and an automatic shut-off valve. Torque control is obtained by preloading the torsion bar to the torque desired. When the resistance of the fastener being run becomes equal to the torque preloaded in the torsion bar, the extra clearance in the flutes of the locking collar allows the torsion bar to flex a few degrees beyond its original setting.

Acting like a spring, the torsion bar snaps back, supplying additional impetus to the hammer, causing the hammer to rebound higher and trip the automatic shut-off valve, instantly stopping the tool. By varying the setting of the torsion bar, using different torsion bars and/or different size tools, torques from 6 to 90 ft.-lbs. (8.14 to 122 Nm) can be accurately obtained time after time.

Ball and cam mechanism converts air motor torque into powerful rotary impacts.

Tough steel anvil transfers blows from impact hammer to the fastener.

Adjustable torsion bar signals shutoff device when preset torque is reached.

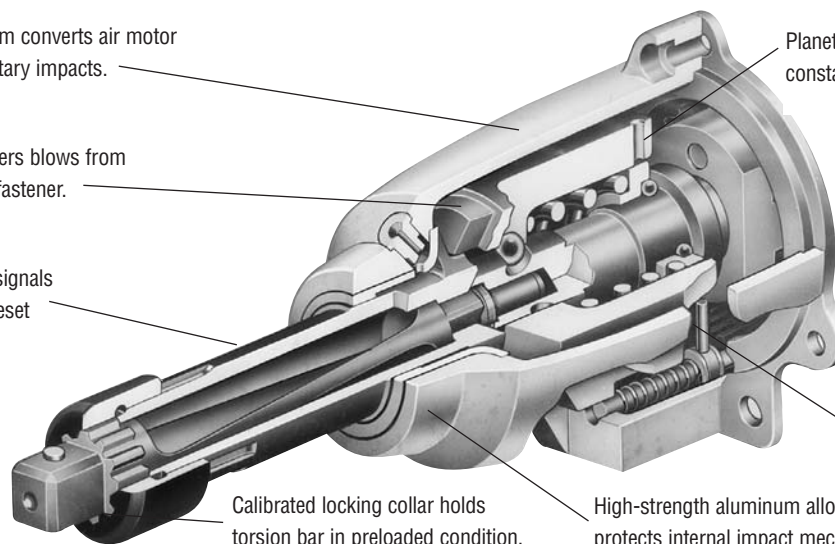

Planetary gear drive delivers smooth constant speed from motor.

Automatic shutoff stops tool when preset torque is reached.

Calibrated locking collar holds torsion bar in preloaded condition.

High-strength aluminum alloy hammer case protects internal impact mechanism parts.

Electric Impact Tools

For applications where the use of compressed air is not practical, IR offers a complete line of electric Impact Tools in 3/8, 1/2, 3/4 and 1-inch drive sizes. All models are ranked according to the Super Duty/Heavy Duty/Standard Duty ratings, and incorporate the same high quality of design and construction that has made Ingersoll-Rand the world leader in Impact Tools.



Electric Impact Tools

3/8" to 1" Industrial Production Class



■ 8005



■ 8055

Features

- Full ball bearing construction throughout for maximum performance
- High quality, heat treated steel gears for longer life
- Full power in reverse for removing bolts, nuts, studs and lag screws
- Lightweight cast aluminum housing and handle reduce operator fatigue
- Heavy duty 3-conductor cord – grounding required
- Delivers high torque for maximum efficiency



■ 8056



■ 8049

Model	Drive Description	Handle	Free Speed rpm	Impacts per minute	Maximum Torque		Recomm. Torque Range		Weight, less socket lb.	Length, less socket in.	Side to Center Distance in.	amps	volts	Chord Length
					ft.-lb.	Nm	ft.-lb.	Nm						
8005	3/8" square	Pistol	2000	2200	85	115	5-50	7-68	4 1/2	10 1/8	1 3/8	3.0	120 AC	10'
8049	1/2" square	Pistol	1900	2000	290	393	30-180	41-244	6 3/4	11 11/16	1 5/8	5.0	120 AC	10'
8053	1/2" square	Pistol	1900	1900	330	448	50-225	68-305	7	10 1/4	1 5/8	5.0	120 AC/DC	15'
8053QC	7/16" hex QC	Pistol	1900	1900	300	407	50-200	68-272	7	11	1 5/8	5.0	120 AC/DC	15'
8055	3/4" square	Pistol	1700	1725	450	610	100-375	136-509	10	11 7/8	1 3/4	7.5	120 AC/DC	8'
8062	5/8" hex QC	Pistol	1700	1725	400	542	100-350	136-475	10	12 7/8	1 3/4	7.5	120 AC/DC	8'
8056	1" square	Grip	800	900	750	1017	300-600	407-814	32 1/2	14 1/8	2 3/8	10.0	120 AC/DC	15'

Tools comply with OSHA requirements and are UL listed.

Drive Size	Super Duty		Heavy Duty		Standard Duty		Torque Control		Electric	
	Series	Page	Series	Page	Series	Page	Series	Page	Series	Page
3/8"	2902	44	1702	44			5020	57	8005	60
3/8"	2903	44	2904	44						
7/16" Quick Change					2131	45	5020	57		
7/16" Quick Change							5040	57		
1/2"	2906	45	2707	45	2705	45	5040	57	8053	60
1/2"					2904	45			8049	60
1/2"					2131	45				
5/8"	2908	51								
5/8" Quick Change									8062	60
3/4"	2925	51	1720	51					8055	60
3/4"			2161P	51						
1"	2934	52	1734	52	1720	51			8056	60
1"	2940	53	1712	52	2171P	51				

Pressure-Feed Lubrication System

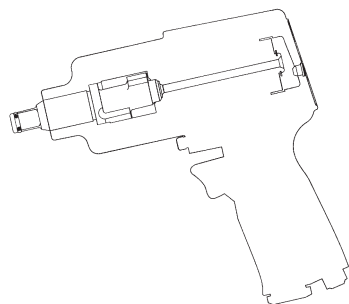

Ingersoll-Rand uses a "pressure-feed" lubrication system on all Twin-Hammer and Jumbo Hammer Impact Mechanisms. This exclusive system allows the operator to externally inject grease into a chamber through a grease fitting in the rear of the motor housing.

Air pressure from the motor force feeds the right amount of grease from the chamber and through the rotor, distributing a film of protective grease

on the hammer mechanism. This system insures the continuous lubrication of critical hammer parts, resulting in longer, trouble-free life.

Use Cat. No. R000A2-228 Metal Grease Gun and Cat. No. 100 Grease, or equivalent. This grease has the right viscosity to flow through the small orifice in the rotor and anvil.

Power Regulator System

Some Twin-Hammer and Jumbo Hammer tools are equipped with a combination power regulator/reverse valve. This design allows operators to adjust power output, to prevent over-torquing on delicate work, in one direction—while maintaining full power in the opposite direction. The power output in either direction is designated by the numbers "0" thru "5". Number 5 designates maximum power.

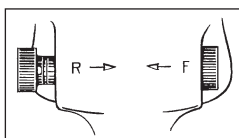

Forward:

Regulator on 3 reduces power output. Switching to **reverse** automatically maintains full power.

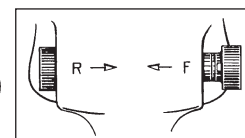

Reverse:

Regulator on 3 reduces power output. Switching to **forward** automatically maintains full power.

Regulator on 5:

Forward, maximum power output
Reverse, maximum power output

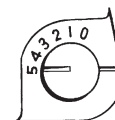

Impact Tools

Air Impact Tools – Industrial Production Class

Model	Drive Description	Handle	Free Speed rpm	Impacts per minute	Maximum Torque		Recomm. Torque Range		Weight, less socket		Length, less socket		Side to Center Distance		Size Hose Recomm.		cfm
					ft.-lb.	Nm	ft.-lb.	Nm	lb.	kg	in.	mm	in.	mm	in.	mm	

3/8" Impact Tools

2902P1	3/8" square	Pistol	10,000	1500	140	190	20-120	27-163	2 1/2	1.25	5 1/2	140	1 3/8	35	5/16	8	15
2903P2	3/8" square	Pistol	6000	1200	205	278	30-170	41-230	4 13/16	2.18	5 5/8	143	1 3/8	35	3/8	10	21
2115PTi	3/8" square	Pistol	15,000	1500	250F	339	25-250	34-312	2.4	1.1	5 3/4	146	1 1/8	29	3/8	10	17
	Reverse Bias				280R	378											
2115P4Ti	1/4" hex QC	Pistol	15,000	1500	250F	339	25-230	34-312	2.4	1.1	5 3/4	146	1 1/8	29	3/8	10	17
	Reverse Bias				280R	378											
1702SB1	3/8" square	Straight	10,000	1500	105	142	13-85	18-115	2 1/2	1.12	5 7/8	149	1	25	5/16	8	13
1702P1	3/8" square	Pistol	10,000	1500	125	170	20-100	27-136	2 3/4	1.25	5 1/2	140	1 3/8	35	5/16	8	15
1702P4	1/4" hex QC	Pistol	10,000	1500	125	170	20-100	27-136	2 3/4	1.25	5 1/2	140	1 3/8	35	5/16	8	15

1/2" Impact Tools

2906P1	1/2" square	Pistol	5000	1200	500	678	40-350	54.2-475	6	2.72	6 7/8	175	1 11/32	34	3/8	10	23
2903P1	1/2" square	Pistol	6000	1200	220	298	30-185	41-250	4 13/16	2.18	5 5/8	143	1 3/8	35	3/8	10	21
2707P1	1/2" square	Pistol	7750	1300	450	610	40-275	54-373	6	2.72	6 1/2	165	1 3/8	35	5/16	8	26
2135PTi	1/2" square	Pistol	9500	1250	625	848	50-600	68-814	3.95	1.79	7.34	186	1 3/8	35	3/8	10	24
	Reverse Bias				700	949											
2131P7	7/16" hex QC	Pistol	9500	1250	625	848	50-600	68-814	3.95	1.79	7.34	186	1 3/8	35	3/8	10	24
	Reverse Bias				700	949											
2705P1	1/2" square	Pistol	8500	1200	400	542	40-200	54-271	5 5/8	2.55	6 3/4	171	1 11/32	34	3/8	10	23
2125PTi	1/2" square	Pistol	15,000	1500	290	339	25-230	34-312	2.4	1.1	5 3/4	146	1 1/8	29	3/8	10	17
	Reverse Bias				280	378											

3/4" Impact Tools

2925P1Ti	3/4" square	Pistol	5200	1050	1450	1972	350-1100	476-1496	1 17/8	5.39	8 7/8	225	1 3/4	44	1/2	13	60
2925RBP1Ti	3/4" square	Pistol	5200	1050	1600 R	2176	400-1400	544-1904	1 17/8	5.39	8 7/8	225	1 3/4	44	1/2	13	60
	Reverse Bias				1300 F	1768											
2920B1	3/4" square	Grip	5000	950	1100	1495	250-800	339-1085	1 33/16	5.98	12 1/2	318	1 29/32	49	1/2	13	36
2920B9	3/4" sq. at 90°	Grip	5000	950	550	949	125-400	203-678	2 311/16	10.75	17 1/2	445	1 15/16	43	1/2	13	36
2161P	3/4" square	Pistol	5750	1025	1250	1700	250-900	340-1224	1 11/4	5.10	8 1/2	216	1 3/4	44	1/2	13	55
1720P1	3/4" square	Pistol	5500	1000	1000	1360	200-600	271-813	1 17/8	5.39	7 5/8	194	1 29/32	48	1/2	13	40
1720B1	3/4" square	Grip	5500	1000	1000	1360	200-600	271-813	1 33/16	6.27	11 3/4	299	1 29/32	48	1/2	13	40
2141P	3/4" square	Pistol	7250	1175	1200R	1492	200-900	271-1220	7.0	3.2	8.2	208	1 3/4	44	1/2	13	40
					1000F	1492											
2141P3	#4 spline	Pistol	7250	1175	1200R	1492	200-900	271-1220	7.0	3.2	8.2	208	1 3/4	44	1/2	13	40

Model	Drive Description	Handle	Free Speed rpm	Impacts per minute	Maximum Torque		Recomm. Torque Range		Weight, less socket		Length, less socket		Side to Center Distance		Size Hose Recomm. in. mm	cfm
					ft.-lb.	Nm	ft.-lb.	Nm	lb.	kg	in.	mm	in.	mm		
2940A1**	No. 5 spline	Grip O.T.	5000	850	2000	2710	1000-1600	1360-2170	22	9.98	12 ¹ / ₄	311	2 ³ / ₁₆	56	3/4 19	58
2940A2	1" square	Grip O.T.	5000	850	2000	2710	1000-1600	1360-2170	22	9.98	12 ¹ / ₄	311	2 ³ / ₁₆	56	3/4 19	58
2940B1**	No. 5 spline	Grip I.T.	5000	850	2000	2710	1000-1600	1360-2170	22	9.98	12 ¹ / ₄	311	2 ³ / ₁₆	56	3/4 19	58
2940B2	1" square	Grip I.T.	5000	850	2000	2710	1000-1600	1360-2170	22	9.98	12 ¹ / ₄	311	2 ³ / ₁₆	56	3/4 19	58
2940P2	1" square	Pistol	4000	810	2000	2710	1000-1600	1360-2170	22 ⁷ / ₈	10.4	9 ⁷ / ₈	251	2 ³ / ₁₆	56	3/4 19	58
2934A2	1" square	Grip O.T.	6600	750	1500	2030	500-1100	678-1490	18 ¹ / ₂	8.39	11 ¹ / ₄	286	2 ³ / ₁₆	56	3/4 19	47
2934B1**	No. 5 spline	Grip I.T.	6600	750	1500	2030	500-1100	678-1490	18 ¹ / ₂	8.39	11 ¹ / ₄	286	2 ³ / ₁₆	56	3/4 19	47
2934B2	1" square	Grip I.T.	6600	750	1500	2030	500-1100	678-1490	18 ¹ / ₂	8.39	11 ¹ / ₄	286	2 ³ / ₁₆	56	3/4 19	47
2934B9	1" sq. at 90°	Grip I.T.	5300	780	750	1624	250-500	678-1355	35 ³ / ₄	16.2	18 ⁵ / ₈	473	1 ¹⁵ / ₈	41	3/4 19	47
2934P2	1" square	Pistol	5300	825	1500	2030	500-1100	678-1490	20	9.07	8 ⁵ / ₈	219	2 ³ / ₁₆	56	3/4 19	47
1734A1**	No. 5 spline	Grip O.T.	6000	800	1400	1904	450-1000	612-1860	18 ³ / ₈	8.34	11 ¹ / ₄	286	2 ³ / ₁₆	56	3/4 19	47
1712B2	1" square	Grip I.T.	6000	800	1350	1836	450-1000	612-1860	18 ¹ / ₄	8.28	11 ¹ / ₄	286	2 ³ / ₁₆	56	3/4 19	47
1712P2	1" square	Pistol	6000	800	1350	1836	450-1000	612-1860	18 ¹ / ₄	8.28	11 ¹ / ₄	286	2 ³ / ₁₆	56	3/4 19	56
2925P3Ti	1" square	Pistol	5200	1050	1450	1972	350-1100	476-1496	11 ⁷ / ₈	5.39	8 ⁷ / ₈	225	1 ³ / ₄	44	1/2 13	60
2925B2Ti	1" square	Grip I.T.	6500	900	1600	2170	350-1400	475-1904	14	6.35	12 ³ / ₈	314	1 ⁵ / ₈	41	1 ¹ / ₂ 13	60
2925RB2Ti	1" square Reverse Bias	Grip I.T.	6500	900	1700R 1500F	2305 2034	F300-1300 R400-1500	407-1763 544-2034	14	6.35	12 ³ / ₈	314	1 ⁵ / ₈	41	1 ¹ / ₂ 13	60
2925RBP3Ti	1" square Reverse Bias	Pistol	5200	1050	1600 R 1300 F	2176 1768	400-1400 300-950	544-1904 408-1292	11 ⁷ / ₈	5.39	8 ⁷ / ₈	225	1 ³ / ₄	44	1/2 13	60
2920B3	1" square	Grip	5000	950	1100	1495	250-800	339-1085	13 ³ / ₁₆	5.98	12 ¹ / ₂	318	1 ²⁹ / ₃₂	49	1/2 13	36
2171P	1" square	Pistol	5750	1025	1250	1700	250-900	340-1224	11 ¹ / ₄	5.10	8 ¹ / ₂	216	1 ³ / ₄	44	1/2 13	55
1720P3	1" square	Pistol	5500	1000	1100	1490	250-750	340-1016	11 ⁷ / ₈	5.39	7 ⁵ / ₈	194	1 ²⁹ / ₃₂	48	1/2 13	40
1720B3	1" square	Grip	5500	1000	1100	1490	250-750	340-1016	13 ³ / ₁₆	6.27	11 ³ / ₄	299	1 ²⁹ / ₃₂	48	1/2 13	40

Impact Tools

Air Impact Tools – Maintenance/Automotive Class

Model Number	Performance Rating	Working Torque Range ft.-lb. (Nm)	Maximum Torque ft.-lb. (Nm)	Blows Per Min.	Free Spd. (rpm)	Standard Bolt Cap. in. (mm)	Weight lbs. (kg)	Length in. (mm)	Av. Air Consump. cfm (l/min)	@ Load cfm (l/min)	Sound dBA (Press./Power)	Air Inlet NPTF in.	Min. Hose Size in. (mm)
3/8" Square Drive													
IR211	Hvy.Dty.	20–125 (27–170)	150 (204)	1,500	10,000	3/8 (10)	2.4 (1.09)	6.6 (168)	2.5 (71)	11 (311)	104/117	1/4	3/8 (10)
IR212	Spr.Dty.	20–150 (27–204)	180 (245)	1,500	10,000	7/16 (11)	2.89 (1.31)	6 (152)	2.5 (71)	11 (311)	97.5/110.5	1/4	3/8 (10)
IR215	Hvy.Dty.	15–300 (20–176)	160 (217)	1,600	9,500	7/16 (11)	2.89 (1.31)	6.125 (156)	3.0 (85)	13 (368)	80.6/93.6	1/4	3/8 (10)
IR216	Spr.Dty.	15–160 (20–217)	175 (232)	1,800	8,000	7/16 (11)	2.89 (1.31)	6.125 (156)	3.0 (85)	13 (368)	97.5/110.5	1/4	3/8 (10)
IR2112	Ult.Dty.	25–200 (34–272)	260 (354)	1,500	14,500	7/16 (11)	2.65 (1.20)	5.625 (143)	4 (113)	17 (476)	94.9/107.9	1/4	3/8 (10)
1/2" Square Drive													
IR2121	Ult.Dty.	25–200 (34–272)	260 (312)	1,500	14,500	7/16 (11)	2.65 (1.2)	5.625 (143)	4 (113)	17 (476)	94.9/107.9	1/4	3/8 (10)
IR225	Hvy.Dty.	25–200 (34–272)	325 (441)	1,200	7,500	1/2 (13)	4.25 (1.93)	6.625 (168)	4 (113)	16.3 (456)	90.5/103.5	1/4	3/8 (10)
IR231C	Spr.Dty.	25–300 (34–408)	470 (610)	1,200	8,000	9/16 (14)	5.8 (2.63)	7.3 (185)	4.2 (119)	22 (623)	102/115	1/4	3/8 (10)
IR231H	Spr.Dty.	25–300 (34–408)*	470 (610)	1,200	8,000	9/16 (14)	5.8 (2.63)	7.3 (185)	4.2 (119)	22 (623)	91.2/104.2	1/4	3/8 (10)
IR231H-2	Spr.Dty.Ext.Anv.	50–400 (68–544)*	450 (610)	1,250	8,000	9/16 (14)	6.0 (2.72)	9.3 (180)	4.8 (136)	23 (651)	91.2/104.2	1/4	3/8 (10)
IR235	Hvy.Duty	25–225 (34–306)	375 (510)	1,200	9,500	1/2 (13)	5.42 (2.46)	7.75 (197)	4 (113)	17 (474)	104.2/111.6	1/4	3/8 (10)
IR244A	Spr.Dty.	40–350 (54–476)	500 (680)	1,300	7,000	5/8 (16)	6.0 (2.72)	7.3 (185)	5.4 (153)	21 (595)	105/109.3	1/4	3/8 (10)
IR244A-2	Spr.Dty.Ext.Anv.	40–350 (54–476)	500 (680)	1,300	7,000	5/8 (16)	6.28 (2.85)	9.5 (241)	5.4 (153)	21 (595)	105/109.3	1/4	3/8 (10)
IR2131A	Ult.Dty.	50–400 (68–544)**	450 (612)	1,250	9,500	9/16 (14)	4.5 (2.04)	7.1 (180)	4.8 (136)	23 (651)	89/102	1/4	3/8 (10)
IR2131A-2	Ult.Dty.Ext.Anv.	50–400 (68–544)**	450 (612)	1,250	9,500	9/16 (14)	4.8 (2.18)	9.1 (231)	4.8 (136)	23 (651)	89/102	1/4	3/8 (10)
IR2131QT	Ultra Duty	50-400 (68-544)**	450 (612)	1,250	9500	9/16 (14)	4.5 (2.04)	7.1 9180	4.8 (136)	23 (651)	82	1/4	3/8 (10)
IR2131QT-2	Ultra Duty	50-400 (68-544)**	450 (612)	1,250	9500	9/16 (14)	4.8 (2.18)	9.1 (231)	4.8 (136)	23 (651)	82	1/4	3/8 (10)
3/4" Square Drive													
IR252	Std.Dty.	100–500 (136–680)	750 (1,020)	1,200	6,500	1 (25)	8.6 (3.9)	9 (229)	7.5 (212)	28 (793)	92.1/105.1	3/8	1/2 (13)
IR258	Heavy Duty	200-800 (272-1,088)	1,000 (1,360)	1,100	6,200	1 (25)	10.77 (4.89)	9.8 (249)	8 (226)	30 (835)	93.7/106.7	3/8	1/2 (13)
IR261	Spr.Dty.	200–900 (272–1,224)	1,100 (1,496)	1,000	5,500	1 (25)	12.4 (5.62)	8.8 (224)	9.5 (269)	38 (1076)	101.1/114.1	3/8	1/2 (13)
IR261-3	Spr.Dty.Ext.Anv.	200–900 (272–1,224)	1,100 (1,496)	1,000	5,500	1 (25)	13 (5.90)	11.8 (300)	9.5 (269)	38 (1076)	101.1/114.1	3/8	1/2 (13)
IR261-6	Spr.Dty.Ext.Anv.	200–900 (272–1,224)	1,100 (1,496)	1,000	5,500	1 (25)	13.7 (6.21)	14.8 (376)	9.5 (269)	38 (1076)	101.1/114.1	3/8	1/2 (13)
IR2141	Ult.Dty.	200–900 (271–1,220)	1,200 (1,627)	1,175	7,250	1 (25)	7 (3.2)	8.2 (208)	9.5 (269)	40 (1133)	00/000	3/8	1/2 (13)
IR2161XP	Ult.Dty.	300–1,000 (407–1,356)	1,250 (1,695)	1,025	6,000	1 (25)	11.8 (5.35)	8.5 (216)	10 (283)	46 (1303)	98/111	3/8	1/2 (13)
IR2161XP-6	Ult.Dty.	300–1,000 (408–1,360)	1,250 (1,695)	1,025	6,000	1 (25)	13.1 (5.95)	14.5 (368)	10 (283)	46 (1303)	98/111	3/8	1/2 (13)
1" Square Drive													
IR280	Spr.Dty.	150–1,000 (204–1,360)	1,600 (2,176)	750	6,000	1 1/4 (32)	22 (9.98)	13 (330)	10 (283)	55 (1557)	109.1/122.1	1/2	1/2 (13)
IR271	Spr.Dty.	200–900 (272–1,224)	1,100 (1,496)	1,000	5,500	1 1/4 (32)	12.5 (5.67)	8.9 (226)	9.5 (269)	39 (1104)	101.1/114.1	3/8	1/2 (13)
IR280-6	Spr.Dty.Ext.Anv.	150–1,000 (204–1,360)	1,600 (2,176)	750	6,000	1 1/4 (32)	23.8 (10.80)	18.5 (470)	10 (283)	55 (1557)	109.1/122.1	1/2	1/2 (13)
IR280-S6	#5Sp.SD.Ext.Anv.	150–1,000 (204–1,360)	1,600 (2,176)	750	6,000	1 1/4 (32)	23.8 (10.80)	18.5 (470)	10 (283)	55 (1557)	109.1/122.1	1/2	1/2 (13)
IR285A	Hvy.Dty.	100–1,000 (136–1,360)	1,450 (1,972)	750	5,000	1 1/4 (32)	22 (10)	13.2 (335)	10 (283)	37 (1047)	107/120	1/2	1/2 (13)
IR285A-6	Hvy.Dty.Ext.Anv.	100–1,000 (136–1,360)	1,450 (1,972)	750	5,000	1 1/4 (32)	25.2 (11.43)	20.1 (511)	10 (283)	37 (1047)	107/120	1/2	1/2 (13)
IR285A-S6	#5Sp.HD.Ext.Anv.	100–1,000 (136–1,360)	1,450 (1,972)	750	5,000	1 1/4 (32)	25.2 (11.43)	20.1 (511)	10 (283)	37 (1047)	107/120	1/2	1/2 (13)
IR290	Spr.Dty.	150–1,000 (204–1,360)	1,600 (2,176)	800	6,000	1 1/4 (32)	21.9 (9.93)	9.75 (248)	10 (283)	60 (1699)	104.6/117.6	1/2	1/2 (13)
IR290-S	#5Sp.Spr.Dty.	50–1,000 (204–1,360)	1,600 (2,176)	800	6,000	1 1/4 (32)	21.9 (9.93)	10 (254)	10 (283)	60 (1699)	104.6/117.6	1/2	1/2 (13)
IR293	Spr.Dty.	1,000–1,600 (1,360–2,176)	2,000 (2,720)	810	3,500	1 3/8 (35)	22.8 (10.34)	11.3 (287)	12 (340)	64 (1812)	90.3/103.3	1/2	1/2 (13)
IR293-S	#5Sp.Spr.Dty.	1,000–1,600 (1,360–2,176)	2,000 (2,720)	810	3,500	1 3/8 (35)	22.8 (10.34)	11.3 (287)	12 (340)	64 (1812)	90.3/103.3	1/2	1/2 (13)
IR295	Hvy.Dty.	100–1,000 (136–1,360)	1,450 (1,972)	750	5,000	1 1/4 (32)	22 (9.98)	10.5 (267)	10 (283)	37 (1047)	N/A	3/8	1/2 (13)
IR295-S	#5Sp.Hvy.Dty.	100–1,000 (136–1,360)	1,450 (1,972)	750	5,000	1 1/4 (32)	21.18 (9.61)	10.5 (267)	10 (283)	37 (1047)	N/A	3/8	1/2 (13)
IR2080-6	Ult.Dty.	150-1,200 (204-1,627)	1,600 (2,305)	950	6,800	1 1/4 (32)	16 (7.3)	21.48 (546)	12 (336)	58 (1624)	103.8/116.8	1/2	1/2 (13)
IR2171XP	Ult.Dty.	300–1,000 (408–1,358)	1,250 (1,695)	1,025	6,000	1 (25)	13.1 (5.95)	12.5 (318)	10 (282)	46 (1303)	98/111	1/2	1/2 (13)
IR2080	Ult.Dty.	150-1,200 (204-1627)	1,600 (2,305)	950	6,800	1 1/4 (32)	14 (6.4)	15.38 (391)	12 (336)	58 (1624)	103.8/116.8	1/2	1/2 (13)

WARRANTY

IMPACT TOOLS

Ingersoll-Rand warrants to the original user its impact tool products to be free of defects in material and workmanship for a period of one year from the date of purchase. IR will repair, without cost, any Product found to be defective, including parts and labor charges, or at its option, will replace such Products or refund the purchase price less a reasonable allowance for depreciation, in exchange for the Product. Repairs or replacements are warranted for the remainder of the original warranty period.

If any product proves defective within its original one year warranty period, it should be returned to an appropriate Ingersoll-Rand Service Distributor, transportation prepaid with proof of purchase or warranty card.

This warranty does not apply to Products which IR has determined to have been misused or abused, improperly maintained by the purchaser: or where the malfunction or defect can be attributed to the use of non-genuine IR parts.

IR makes no other warranty, and all implied warranties including any warranty of merchantability or fitness for a particular purpose are limited to the duration of the expressed warranty period as set for the above. IR's maximum liability is limited to the purchase price of the Product and in no event shall IR be liable for any consequential, indirect, incidental, or special damages of any nature arising from the sale or use of the Product, whether based on contract, tort, or otherwise.

Questions? Parts? Service?



**Ontario's Largest
Pneumatic & Hydraulic Tool Distributor**

1-2430 Lucknow Drive, Mississauga, Ontario L5S 1V3. Tel: 905-672-5557 Fax: 905-672-5559
Email: sales@dobcoeqp.com www.dobcoeqp.com

